

# Public Spaces



Implementation of community goals and policies is rooted in the public infrastructure necessary to support a community's basic needs and future growth. These needs are similar in most communities: roads, transit, libraries, schools, parks, public plazas, city offices, police and fire stations, churches, bridges and utilities. How we address these needs defines the characteristics of a great community.

KTU+A has the knowledge and expertise to create aesthetically enduring and sustainable projects. Successfully balancing social, economic, and environmental interests is at the heart of KTU+A's process for providing unique solutions for our communities. After carefully considering the site's natural features, open space, architecture, and urban design, we deliver award-winning solutions that provide connection, civic identity, address the needs of the community, and reflect their aspirations.

- Civic Buildings
- Libraries
- Fire Stations
- Churches
- Streets
- Transit Facilities
- Parking Structures
- Bridges
- Utilities



3916 Normal Street  
San Diego, CA 92103  
619 294-4477  
[www.ktua.com](http://www.ktua.com)



Market Leader:  
Kurt Carlson, ASLA  
[kurt@ktua.com](mailto:kurt@ktua.com)

# Public Spaces

## LIBRARIES/COMMUNITY CENTERS

- Florence Riford Library, La Jolla
- Porterville Library and Community Center, Porterville
- Mission Valley Library, San Diego\*\*
- Point Loma Library, San Diego
- San Diego State University Love Library Expansion, San Diego
- Point Loma Nazarene University Ryan Library Addition, San Diego
- Torrance Cultural Arts Center, Torrance

## PUBLIC HEALTH AND SAFETY

- San Diego County Juvenile Hall Expansion, San Diego
- Edgemoor Skilled Nursing Facility, Santee
- San Diego County Medical Examiners, San Diego
- North County Regional Center, Vista
- Rancho Santa Fe Fire Station, Rancho Santa Fe
- Carmel Valley Fire Station, San Diego
- Golden Hill Fire Station, San Diego

## CHURCHES

- Resurrection Catholic Church, Escondido
- St. Michael's Catholic Church, Poway
- Sts. Peter & Paul Catholic Church, Rancho Cucamonga
- Church of Saint Luke, Rancho San Diego
- First Unitarian Church, San Diego
- Rancho Bernardo Community Church, San Diego
- Youth for Christ Church, San Diego

- St. Bartholemews Church, San Diego
- Tierrasanta Baptist Church, San Diego
- St. James Catholic Church, Solana Beach
- Solana Beach Presbyterian Church, Solana Beach
- St. Francis Catholic Church, Vista

## BRIDGES

- Main Street Bridge, Temecula
- Willow Street Bridge Renovation, Chula Vista
- El Camino del Norte Bridge Habitat Restoration Plan, Encinitas
- Lake Hodges Pedestrian/Bike Bridge Conceptual Studies, San Diego

## TRANSIT PLANS AND CORRIDORS

- State Route 15/Mid-City Bus Rapid Transit Plan, San Diego\*\*
- San Diego Trolley Mid-Coast Corridor Feasibility Study, San Diego
- San Diego State University to Downtown Bus Rapid Transit Study, San Diego
- San Diego Trolley Mission Valley East Patron Access Study, San Diego
- University Town Center Super Loop Transit Study, San Diego
- San Diego Trolley Old Town Line Extension, San Diego

## STREET DESIGN

- Armada Drive, Carlsbad
- El Camino Real Widening, Carlsbad
- Cannon Road, Carlsbad
- Interstate 5/Palomar Airport Road Interchange, Carlsbad
- Orange Avenue, Olympic Parkway and Interstate 805 Interchanges, Chula Vista
- Downtown Delano Streetscape Improvements, Delano
- Mission Road Widening, Fallbrook
- State Route 168, Fresno County
- Palm Avenue, Imperial Beach
- Ardath Road Realignment, La Jolla
- Science Center Drive, La Jolla
- State Route 125, La Mesa
- Main Street Promenade, Lemon Grove
- 8th Street Corridor Smart Growth Project, National City
- State Route 76, Oceanside
- Downtown Porterville Streetscape Improvements, Porterville
- Old Coach Road, Poway
- Hazard Center Drive, San Diego
- Lindbergh Field Improvement Plans, San Diego
- Ballpark Infrastructure, San Diego
- C Street Master Plan, San Diego
- Caltrans Landscape Architectural Services, District 11, San Diego
- Camino del Mar, Del Mar
- Carmel Valley Road, San Diego
- Carmel Country Road, Carmel Mountain Road and Del Mar Heights Road, San Diego
- Gaslamp Quarter, San Diego
- Park Boulevard, San Diego

\*\* Award Winning Project



Mission Valley Library, San Diego



Main Street Bridge, Temecula

# Public Spaces

- Ocean View Hills Community, San Diego
- Sorrento Valley Road Closure Study, San Diego
- Shelter Island, San Diego
- Genesee Avenue Widening, San Diego
- State Route 56/Camino del Sur Interchange, San Diego
- Interstate 805/La Jolla Village Drive Interchange, San Diego
- State Route 163/Clairemont Mesa Blvd. Interchange, San Diego
- Discovery Hills Streetscape Improvements, San Marcos
- Downtown Tulare Streetscape Improvements, Tulare
- Valley Center Median, Valley Center
- McDowell Road, Phoenix, AZ

## PARKING STRUCTURES

- San Diego State University Parking Structures, San Diego
- Grossmont Medical Office Building Parking Structure, La Mesa
- Scripps La Jolla Entry Plaza and Parking Structure, La Jolla
- Scripps Green Hospital Parking Structure, La Jolla
- University of San Diego Parking Structure, San Diego
- Cal State San Marcos Parking Structure Infrastructure, San Marcos
- Garfield High School Parking Structure, San Diego
- Park Row, San Diego
- St. Joseph's Medical Office Building Parking Structure, Santa Ana

## UTILITIES

- UCSD Medical Center Utility Bridge, San Diego
- Penasquitos View Trunk Sewer Replacement, San Diego
- Moreno Lakeside Pipeline and Lakeside Pump Station, Lakeside
- Otay Water District 450-1 and 680-1 Pump Station, Chula Vista
- Point Loma Wastewater Treatment Plan Site Improvements, San Diego
- Aqua Hedionda Pump Station Visual Study and Site Design, Carlsbad
- Twin D and Bressi Pump Stations, Carlsbad
- Lake Hodges Pump Station Concept Plan, San Diego



*Ballpark Infrastructure, San Diego*

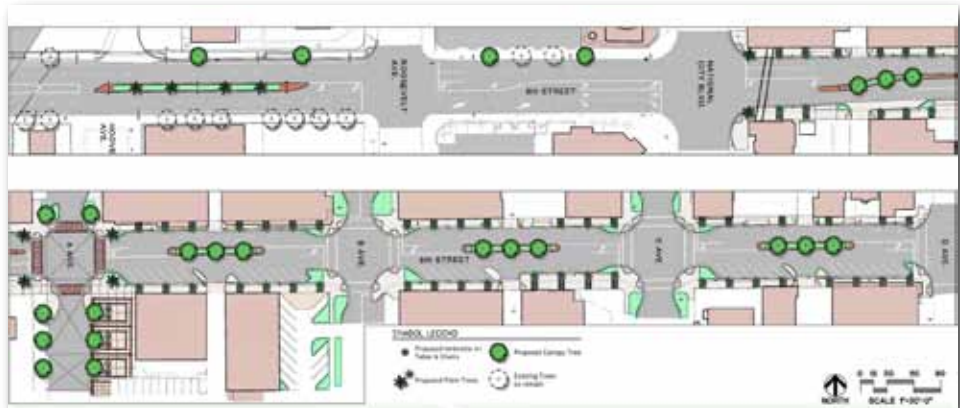

*8th Street Corridor, National City*



*Valley Center Heritage Trail, Valley Center*



*Old Coach Road, Poway*



*Mission Valley Library, San Diego*

## KTU+A Departments

### Planning

- Community Planning
- Mobility
- Resource Management

### Federal Planning

- Master Plans
- MILCON Documentation
- Basic Facility Requirements
- Asset Evaluations
- Capital Improvement Plans
- Design Guidelines
- Special Studies

### Landscape Architecture

- Public Spaces
- Parks and Recreation
- Health Care
- Education
- Housing
- Hospitality
- Office and Retail

### Value Added Services

- Public Outreach
- GIS
- 3D Modeling and Simulations
- Sustainable Design
- Water Management
- Grant Writing

## Public Spaces



## Planning + Landscape Architecture

Established in 1970, KTU+A is a San Diego-based planning and landscape architecture firm whose commitment to balancing human activities with the elements of nature has resulted in award-winning, creative and sustainable projects throughout our community and the southwest.

### Client Objectives

As our client, you can expect quality services that focus on your priorities and meet your deadlines and budgets. As your partner, our staff will provide planning and design solutions that are creative, clearly communicated, and well executed.

### Our Approach

- Collaborate toward a common vision to attain uncommon results.
- Seek solutions that capture the context of the place, preserve existing resources, and integrate the values of the users.
- Shape the intersection of people and place.
- Implement in a sustainable and cost effective manner.
- Evaluate and learn from our project experiences.

### Knowledge and Experience We Bring to Your Project

The planning and design of a project requires an understanding of the regulations and requirements to protect the public's health safety and welfare; an understanding of the most innovative design technologies to meet current and future needs; an understanding of the needs and priorities of the users; and an understanding of the responsibilities of the client in terms of risk management, maintenance, future expansion opportunities and costs. KTU+A takes these responsibilities seriously and strategizes with our clients and the consultant team to ensure the project meets and exceeds its goals and objectives.

### Principals

- Sandra Swaner-Carmona, AICP
- Sharon Singleton, ASLA, CPSM
- Kurt Carlson, ASLA
- Mike Singleton, ASLA, AICP CTP, LEED-AP

### Staff Resources/Licenses/Certifications - 32

- 10 Planners (4 AICP)
- 9 Landscape Architects (9 California and 2 Nevada; 2 LEED AP; 1 LEED Green Associate; 1 AICP Certified Transportation Planner)
- 4 Landscape Designers
- 2 Irrigation Designers (1 Irrigation Association Certified Irrigation Designer)
- 3 GIS Analysts
- 1 Graphic Designer
- 3 Administrators

### Business Certifications

- Women Owned Small Business (Federal)
- Small Business (State of California)



... balancing human activities with the elements of nature