

Healthy Placemaking



ktua

Planning and
Landscape Architecture

KTUA PROFILE | SERVICES

LANDSCAPE ARCHITECTURE

- Civic and Public Works
- Parks and Recreation
- Healthcare
- Education
- Housing
- Hospitality
- Office and Commercial

PLANNING

- Land Use Planning
- Transportation Planning
- Active Transportation Planning
- Recreation Planning
- Resource Planning
- Federal Planning

SUPPORT SERVICES

- Public Outreach
- GIS
- 3D Modeling and Simulations
- Sustainable Design
- Water Management
- Grant Writing

STAFF RESOURCES

- Landscape Architects
- Planners
- Transportation Planners | Engineers
- Facilitators | Interpreters
- Irrigation Designers
- Graphic Designers

As planners and landscape architects, KTUA is focused on the principles of healthy placemaking – a collaborative process for reshaping the public realm of our neighborhoods, communities, and regions. The link between our natural and built environments and the health of individuals, families, and communities is real. Well designed streets, parks, open spaces, public places, and buildings facilitate human connectivity and improve people's mental, physical, and social health. In our vision and our actions, KTUA collaborates with our community leaders, public agencies, private developers, allied professionals, neighbors, and families to develop implementable plans that address social, physical, environmental, and economic goals that shape healthy places. By building support for these plans and projects from the ground up, we provide opportunities for civic engagement and transformative ideas.

OUR PLANNING AND DESIGN PROCESS INCLUDES

- Listening to the community so that we fully understand their needs and desires;
- Creating places that are attractive, convenient, safe, and healthy;
- Designing to encourage social, civic, and physical engagement;
- Protecting, enhancing, and restoring the environment;
- Contributing towards economic growth of the region and the residents;
- Improving the daily lives of people of all ages and abilities by providing options for housing, transportation, education, and social interaction; and
- Maximizing enjoyment and economic benefit while minimizing risk, liability, and injury.

VALUE TO OUR CLIENTS

- The diversity and background of our staff, a collaboration of planners, landscape architects, GIS analysts, facilitators, and graphic artists, allows us to fully understand the larger perspective and implement the fine-grained details that contribute to project success.
- All of our staff members, from the principals to the designers, are hands-on. The team that is working on your project will stay in place from start to finish, ensuring that transitions from one phase of a project to another will be seamless and efficient.

OUR PASSION FOR HEALTHY PLACEMAKING

- KTUA staff members are involved in their communities, from community planning groups and advisory boards to philanthropic groups and student mentoring programs, with the goal of effecting positive change in our neighborhoods.
- KTUA staff members are frequent speakers at the local, regional, and state level on the benefits of forward-thinking planning and design on people, the community and the environment.
- KTUA's efforts to promote planning and design projects that focus on healthy placemaking have been recognized by our professional organizations such as ASLA, APA, ULI, APWA, and SAME.



3916 Normal Street
San Diego, CA 92103
619-294-4477

540 E. Betteravia Road, Suite D 122
Santa Maria, CA 93454

www.ktua.com



UCSD Scripps Institution of Oceanography Coastal Meander Trail

HIGHER EDUCATION | UNIVERSITIES

PUBLIC UNIVERSITIES

San Diego State University

- Aztec Field - Aztec Green ENS 700 Field
- Baseball, Tennis and Aquaplex Facility
- Campus Bike & Skateboard Study
- Chemistry Building
- Confucius Institute
- Cox Arena
- Cuicacalli Suites and Dining Complex
- Destination SDSU
- Engineering Building
- Lot W Recreation Fields
- Love Library Addition
- Nahuatl Healing Garden
- Open Air Theater Renovation
- SDSU East Campus Housing
- Student Activity Center
- Student Fields (AS-Soccer)
- Tenochca Hall Additions
- Tony Gwynn Stadium
- University Tower Addition

Cal State San Marcos

- Athletic Complex Master Plan
- Baseball and Softball Fields
- Campus View Drive Extension, Parking Structure 1, Phase 1
- Campus ADA and Wayfinding Study

University of California San Diego

- Bicycle and Pedestrian Master Plan
- Central Research Services Facility
- Coastal Meander Trail
- East Campus Recreation Area
- Faculty Club
- Gilman Drive Bridge
- Gilman Drive Transit Center
- International Relations and Pacific Studies Building
- NOAA Revegetation
- North Campus Mall
- North Campus Recreation Area
- Preuss School Soccer Field
- Ropes Course
- Scripps Institution of Oceanography Coastal Meander Trail
- Scripps Institution of Oceanography Dry Weather Flow Elimination and Pollutant Source Control Program
- Scripps Institution of Oceanography Eckart Coral Garden
- Social Sciences Building
- Visual Arts Building

University of California San Diego Hillcrest Campus

- Utility Bridge and infrastructure

University of San Diego

- Alumni Center
- Arthur and Marjorie Hughes Center
- Camino and Founders Hall
- Fowler Field and Cunningham Stadium
- Hogan West Tennis Facility
- Immaculata
- Jenny Craig Pavilion
- Law Library
- Learning Commons
- Knauss Center for Business Education
- Maher Memorial Garden
- Maher Pedestrian Mall
- Master Plan Revisions for Athletics, Recreation, Intramural and Clubs
- Paseo de Colachis/Copley Library
- Philip Hahn School of Nursing
- West Hill Parking Structure

PRIVATE UNIVERSITIES

Point Loma Nazarene University

- Cooper Music Center
- Nicholson Student Commons
- Ryan Library Expansion

William Jessup University

- Landscape Master Plan

EF International

- Point Loma Campus



SDSU Nahuatl Healing Garden



University of San Diego Paseo de Colachis

The new Paseo de Colachis expands the central pedestrian promenade at the University of San Diego by closing down an existing two way vehicular street with a median and continues the outdoor plaza and pedestrian mall to serve as an inviting gathering and activity place for students and staff. Vehicular drop-offs are integrated into the design of the plaza at both the west and east ends of the site to accommodate the University's tram service which allows students, staff and visitors access to the rest of campus.

Sitting on a hillside with expansive views out to the Pacific Ocean, a large decorative tile and stone fountain identify the entry to the plaza. This fountain and pedestrian plaza surrounding it forms the gateway into campus. The site is arranged in three distinct landscape spaces: the lawn, the garden, and the plaza, and includes formal gathering plazas with casual furnishings, outdoor classroom spaces, a large lawn for free play and community events, an overlook area, and a native demonstration garden. Accessible paths to every building were accommodated with integrated terraces, formal ramps and stairs to account for the significant grade changes across the entire plaza.

Awards: 2018 APWA San Diego, Project of the Year (\$6-\$25M category)

“ As the prime consultant, it was critical for the project to deliver on time. We worked with sub-consultants to complete concept designs, construction documents, and process improvement and building plans at the city in just eleven months for the plaza and just five months for the library expansion.

– BROOKE WHALEN,
SR. LANDSCAPE ARCHITECT

HIGHER EDUCATION | COMMUNITY COLLEGES



San Diego City College
Early Education Center



Grossmont College Native Gardens

CUYAMACA COLLEGE

- Physical Education Facility

GROSSMONT COLLEGE

- Child Development Center
- Digital Arts and Sculpture Building**
- Health/Sciences Complex
- Landscape Standards
- Landscape Trail Master Plan
- Native and Meditation Gardens
- Parking Structure
- Student Services/Griffin Center

PALOMAR COLLEGE

- Campus Arboretum**
- Howard Brubeck Theater Renovation

MESA COLLEGE

- Irrigation Mainline Loop and Parking Lot

MIRACOSTA COLLEGE

- Art and Music Storage Building**
- Dance Studio**
- Student Services Center
- Biotech and Chemistry Building
- San Elijo Campus Building 400 and Building 600 Outdoor Classroom

ORANGE COAST COLLEGE

- Campus Bike/Skateboard Master Plan

SAN DIEGO CITY COLLEGE

- Child Development Center

SOUTHWESTERN COLLEGE

- Landscape Nursery Technology Center and South Bay Botanical Garden**
- Auto Technology Center
- Facilities & Maintenance Department**
- Jaguar Classroom Village
- Tradewinds Cafe Renovation
- Transit Center
- Tennis Facility
- Campus Master Plan/Design Guidelines
- Student Union Complex
- Instructional Complex #1
- Data Center

**Plans were processed through DSA

NATIVE GARDENS

- Grossmont College Native and Meditation Gardens
- UC San Diego Eckart Coral Garden
- Moreno Valley College Landscape Renovation
- Palomar College Arboretum
- Living Coast Discovery Center Pollinator Garden

“ The new drought-tolerant landscaping is part of Grossmont College’s outdoor education zone. The sustainability project transformed campus landscaping with drought-tolerant native plants, creating outdoor learning labs for Biology and Earth Science courses, while conserving water and campus resources.

– GROSSMONT COLLEGE

HIGHER EDUCATION | CAMPUS HOUSING



UC San Diego Rita Atkinson Graduate Student Housing



The KTUA landscape concept plan for the UCSD 226,000-square foot, 225-bed Rita Atkinson Residences project emphasizes the functionality of sustainable landscape combined with aesthetic expression designed to provide a healthy and pleasing environment for graduate students while achieving a LEED Gold rating.

The \$43 million design-build project minimized site disturbance, recycled existing on-site materials, utilized low water-use planting, rapidly renewable plant materials and permeable pavements, maximized open space, and created strong pedestrian and bicycle connections to the University campus. With KTUA's assistance, the 2-acre site was graded and balanced to avoid off-site export, minimize site walls, and limit disturbance of existing landscape and habitat. Working with the design-build team, KTUA provided an early analysis of applicable points to achieve the LEED rating, particularly in the areas of Sustainable Sites and Water Efficiency.

CAMPUS HOUSING

- Cal Poly San Luis Obispo South Campus Student Housing
- EF International Student Residence
- SDSU Cuicacalli Residential Suites and Dining Complex
- SDSU East Campus Housing
- SDSU Tenochca Hall Additions
- UC Merced Gardenview Suites
- UC San Diego Rita Atkinson Graduate Student Housing
- UC San Diego Matthews Student Housing
- UC San Diego East Campus Apartments
- USD Alcalá/Mission Apartments
- 5030 College (off-campus housing)

Cal Poly San Luis Obispo Student Housing



Photo by Bruce Damonte

EDUCATION | K-12 & CHILD DEVELOPMENT CENTERS

PRIVATE SCHOOLS

- Horizon Prep School
- La Jolla Country Day School

K-12

San Diego City Schools

- Alcott Elementary School Irrigation
- Bayview Elementary School Administration Building and Parking Lot
- Bell Middle School Modernization
- Bird Rock Elementary School Library
- Birney Elementary School Irrigation
- Brooklyn Elementary School Lunch Shelters
- Carson Elementary School Library
- Carver Elementary School Library
- Cesar Chavez Elementary School Classrooms, Admin. Building, Fields/Playgrounds
- Challenger Junior High School
- Clairemont High School Library
- Crown Point Elementary School Library
- Dingeman Elementary School
- Emerson Bandini Elementary School
- Florence Griffith Joyner Elementary School
- Freese Elementary School Irrigation
- Garfield High School
- Gompers Middle School Irrigation
- Hearst Elementary School Library
- Ibarra Elementary School Bridging Documents
- King Elementary School Library
- Kroc Creative, Performing and Media Arts School
- Laura Rodriguez Elementary School
- Lewis Middle School
- Lincoln High School
- McKinley Elementary School Master Plan
- Miramar Ranch Elementary School Irrigation Upgrades
- Mira Mesa High School Whole Site Modernization and Music Education Building
- Mission Bay High School Library
- Morse High School Athletic Fields, Culinary Arts Center, Child Development Center, Campus Modernization
- Muirlands Middle School Library
- Normal Heights Elementary School
- Patrick Henry High School Library and Media Center
- Scripps Ranch High School Modernization and New Classroom
- Scripps Ranch Middle School Bridging Documents

Sweetwater Union High School District

- Eastlake Middle School
- Olympic High School
- Otay Ranch High School
- Rancho Del Rey Middle School
- San Ysidro High School

Grossmont High School District

- El Capitan High School Agricultural Complex
- Santana High School Plaza
- Valhalla High School Master Plan
- Viking Hall, Valhalla High School

Solana Beach Elementary School District

- Pacific Highlands Ranch School Master Plan
- Solana Highlands Elementary School
- Solana Ranch Elementary School

Del Mar Union School District

- Ashley Falls Elementary School
- Torrey Pines High School

Escondido Union High School District

- Orange Glen High School Modernization

CHILD DEVELOPMENT CENTERS

- Grossmont College Child Development Center
- Morse High School Child Development Center
- San Diego City College Early Education Center
- SDSU Child Development Center
- USD Manchester Child Care Center



Morse High School Child Development Center. Design included drought tolerant, low maintenance plant materials and one of the San Diego Union School Districts first drip irrigation systems.



San Diego City College Early Education Center

The 10,000 SF child development center facility will serve as a teaching facility integrated into the college's child development curriculum. Designed to enable students to participate and observe classroom and playground activities, the facility will include two preschool, two toddler and two infant classrooms for up to 72 children. The interior classrooms play a secondary role to the outdoor play and learning environments - play as learning represents some of the newest strategies in child development. Primary spaces include: outdoor areas for various age groups (infant, toddler, pre-school), interior courtyard space, entry space, perimeter landscape.

Landscape Architecture primary elements include: nature play elements (turf berms, slide, playground hut, sand pits, classroom planters, chalkboards, playground deck, and other miscellaneous play elements). Each landscape space is meant to provide a valuable outdoor experience that encourages imaginative play, physical development, and attention restoration. Within the play yards, there are outdoor classrooms and play areas that correspond with each age group. The entry plaza and interior courtyard will provide a sensory experience using a variety of paving materials, a diverse planting palette, lighting and hardscape elements. The project achieved LEED Silver Certification.



HEALTHCARE | ASSISTED LIVING FACILITIES



Silvergate Assisted Living

ASSISTED LIVING FACILITIES

- Americare Silvergate, San Diego
- Casa de las Campanas, San Diego
- Edgemoor Skilled Nursing Facility, Santee
- Southern California Veterans Home, Barstow
- Southern California Veterans Home, Chula Vista
- Sea Crest Village, Carlsbad
- The Glen at Scripps Ranch, San Diego
- Wesley Palms, San Diego

KTUA worked with AmeriCare Health & Retirement on their 10.88-acre site purchased from the Poway Unified School District. The project proposes a mix of residential options with 202 rooms — 48 for independent living, 84 for assisted living, 48 for memory care plus 22 independent living cottages. Rather than surface parking, the project will utilize a large below-grade parking structure, exceeding the city's parking requirements.

KTUA sited larger buildings, the parking and service at the existing wooded north end, minimizing community impacts from the site. Single-story cottages, located at the south end, blend into the existing residential context. The southern perimeter has a linear park running the length of the immediate frontage of the property, creating a buffer between the street and facility. The park will be open to the public and pedestrian friendly.

An extensive pedestrian circulation system offers both regular walking surfaces and trail-like experiences. A swim pool facility, including a spa, will be located in the heart of the cottage area and park area. Recreational amenities such as bocce, and game tables are also available to residents. The project will utilize a gray water system, capturing building water (washers, showers, kitchen, cooling systems), treating it on-site, and then reusing the water for site irrigation.

Edgemoor Skilled Nursing Facility



Mediterranean
Garden

HEALTHCARE | HOSPITALS & MEDICAL OFFICE BUILDINGS



HOSPITALS

- Children's Hospital, San Diego
- El Centro Medical Center Landscape Master Plan
- Kaiser Permanente, Otay Mesa
- Kaiser Permanente Women's Center, La Mesa
- Mercy Hospital Entry Park, San Diego
- Modesto City Hospital Renovation
- Naval Hospital Camp Pendleton Site Planning and Bridging Documents
- Psychiatric Institute of America, Azusa, Long Beach, Rancho Cucamonga, Chula Vista, Bakersfield, San Jose, Redding, Palm Springs, and Stockton
- Rancho Springs Medical Center, Murrieta
- Rancho Springs Women's Health Center, Temecula
- Palmdale Regional Medical Center
- San Geronio Hospital
- Scripps Chula Vista Hospital
- Scripps La Jolla Hospital
- Temecula Valley Hospital
- UCSD Medical Center Tower Modernization

HEALING GARDENS

- Sharp Chula Vista Healing Garden

MEDICAL OFFICE BUILDINGS

- Canyon Springs Hospital Medical Office Building, Cathedral City
- Children's Hospital Medical Office Building, San Diego
- Grossmont Medical Office Building, La Mesa
- Kern Health Center, Kern County
- Maple Street Medical Office Building, San Diego
- Palmdale Medical Office Building
- Pediatrics Specialty Medical Office Building, San Diego
- San Ysidro Health Center
- Scripps Oceanside Medical Office Building
- St. Joseph Medical Office Building Parking Structure, Santa Ana
- XIMed Medical Office Building, La Jolla

Naval Hospital Camp Pendleton

Naval Hospital Camp Pendleton



Photo by LaCasse Photography

KTUA was selected by NAVFAC Southwest to prepare site plan alternatives for the proposed Replacement Hospital at MCB Camp Pendleton. This effort included identifying program requirements, site constraints and opportunities that affected the hospital location options. The alternatives took into account the access, infrastructure, views from and of the site, biological constraints, drainage requirements and other safety issues. A total of four site plans were developed working with major stakeholders. The preferred alternative plan resulted in a more detailed site plan including utility points of connection, probable utility realignments and undergrounding options.

The landscape architectural plans provide design treatments arranged to express qualities of order, integrity, and sustainability to create a timeless building and landscape throughout the 50+ acre site. A hierarchy of roadways, spaces, materials, planting, and entrances provide the

visitor with a coherent way-finding system; landscaped courtyards and plazas provide areas for relaxation, family togetherness, and experience of nature. Exterior materials are linked to elements of the architecture and create a cohesive design of indoor and outdoor spaces, as well as contributing to Silver LEED certification. The project features parking lots designed with bio-swales, permeable paving, and photovoltaic systems; axial access ways leading employees and visitors through landscaped allees to the hospital, entry bridge, auto plaza, dining courtyards, a Memorial Plaza, and interior healing garden. The hospital and utility buildings feature a variety of green roof treatments that contribute to sustainability and the healing environment. KTUA also contributed design treatments for exterior lighting, site furnishings, service emblems, and custom design for the memorialization of winners of The Medal of Honor.

OFFICE & COMMERCIAL

RETAIL DISTRICTS

- Gaslamp Quarter, San Diego
- Old Ferry Landing, Coronado
- Park Boulevard/Adams Avenue, San Diego

SHOPPING CENTERS

- Bay View Plaza, San Diego
- Delano Grapevine Center
- Garrett Ranch, Hemet
- Los Coches Center, Carlsbad
- Hazard Mission Center
- Kimco El Camino North
- Santee Trolley Square

RESTAURANTS

- Coasterra, Harbor Island

OFFICE BUILDINGS

- Allred Collins Corporate Center, San Diego
- AME, La Jolla
- Braille Institute, San Diego
- Centerside Towers, San Diego
- Cornerstone Corporate Center, Carlsbad
- Cubic Balboa Campus, San Diego
- KTUA Office, San Diego
- NBC Building Renovation, San Diego
- One America Plaza, San Diego
- Pacific Center, San Diego
- Plaza Del Mar, San Diego
- Regents Park, La Jolla
- SAIC Campus Point, La Jolla
- San Diego Corporate Center, Del Mar
- San Marcos Civic Corporate Plaza
- State Compensation Fund, Fresno
- Sunroad Corporate Center, La Jolla
- Sunroad Centrum, San Diego
- Torrey Reserve, Del Mar
- University Center, La Jolla
- Viasat Building 11, Carlsbad
- Wells Fargo/401 B Street, San Diego

SCIENCE AND TECHNOLOGY

- Dura Pharmaceuticals, Sorrento Valley
- Gilead Sciences, La Verne
- La Jolla Institute for Allergy and Immunology, La Jolla
- Ligand Pharmaceuticals, La Jolla
- Neurocrine Biosciences, Del Mar
- Nexus Science Center, La Jolla
- Salk Institute Expansion, La Jolla
- Torrey Pines Science, Center, La Jolla

BUSINESS PARKS OFFICE COMPLEXES

- Carlsbad Research Center
- Bridge Point Office Park
- Eastgate Technology Park Reinvestment, San Diego
- Governor Business Park, San Diego
- Parkway Business Center, Poway
- Manchester Pacific Gateway
- Sabre Springs Business Park, San Diego
- Solana Beach Corporate Center
- Stonecrest Business Park
- Union Tribune Site Redevelopment



Delano Grapevine Shopping Center

Gilead Sciences, Lavern



CIVIC & PUBLIC WORKS | CIVIC BUILDINGS, CHURCHES & INFRASTRUCTURE

AIRPORTS

- San Diego Airport Rental Car Center, San Diego
- San Diego International Airport Terminal 2 Modifications
- San Diego Airport Lindbergh Field IAP

LIBRARIES/COMMUNITY CENTERS

- Florence Riford Library, La Jolla
- Mission Valley Library, San Diego
- Nobel Library, San Diego
- Point Loma Library, San Diego
- Point Loma Nazarene University Ryan Library Addition, San Diego
- Porterville Library and Community Center, Porterville
- San Diego State University Love Library Expansion, San Diego
- Santee Community Center, Santee
- Torrance Cultural Arts Center, Torrance

PUBLIC HEALTH AND SAFETY

- Carmel Valley Fire Station, San Diego
- County Juvenile Hall Expansion, San Diego
- Garden Grove Fire Station, Garden Grove
- Golden Hill Fire Station, San Diego
- North County Regional Center, Vista
- Rancho San Diego Sheriff Substation San Diego
- Rancho Santa Fe Fire Station, Rancho Santa Fe
- San Diego County Medical Examiners, San Diego

CHURCHES

- Church of Saint Luke, Rancho San Diego
- First Unitarian Church, San Diego
- Rancho Bernardo Community Church, San Diego
- Resurrection Catholic Church, Escondido
- Saint Bartholemews Church, San Diego
- Saint Francis Catholic Church, Vista
- Saint James Catholic Church, Solana Beach
- Saint Michael's Catholic Church, Poway
- Saints Peter & Paul Catholic Church, Rancho Cucamonga
- Solana Beach Presbyterian Church, Solana Beach
- Tierrasanta Baptist Church, San Diego
- Youth for Christ Church, San Diego

UTILITIES

- Agua Hedionda Pump Station Visual Study and Site Design, Carlsbad
- Huntington Beach Water Operations Center, Huntington Beach
- Lake Hodges Pump Station Concept Plan, San Diego
- Moreno Lakeside Pipeline and Lakeside Pump Station, Lakeside
- Otay Water District 450-1 and 680-1 Pump Station, Chula Vista
- Penasquitos View Trunk Sewer Replacement, San Diego
- Point Loma Wastewater Treatment Plan Site Improvements, San Diego
- San Diego Metropolitan Operations Complex Water Conservation Plan
- Twin D and Bressi Pump Stations, Carlsbad
- UCSD Medical Center Utility Bridge, San Diego

PARKING STRUCTURES

- Cal State San Marcos Parking Structure Infrastructure, San Marcos
- Garfield High School Parking Structure, San Diego
- Grossmont Medical Office Building Parking Structure, La Mesa
- Park Row, San Diego
- Saint Joseph's Medical Office Building Parking Structure, Santa Ana
- San Diego Airport Rental Car Center, San Diego
- San Diego State University Parking Structures, San Diego
- Scripps Green Hospital Parking Structure, La Jolla
- Scripps La Jolla Entry Plaza and Parking Structure, La Jolla
- University of San Diego Parking Structure, San Diego

BRIDGES

- El Camino del Norte Bridge Habitat Restoration Plan, Encinitas
- Lake Hodges Pedestrian/Bike Bridge Conceptual Studies, San Diego
- Main Street Bridge, Temecula
- Willow Street Bridge Renovation, Chula Vista

San Diego Airport Rental Car Center



The 25.5-acre San Diego International Airport Rental Car Center (RCC) serves as a welcoming point of entry for visitors to the San Diego region and an enhancement to the north side of the airport campus. Two distinct “front doors” are located along the north and south sides of the structure. The RCC includes parking for 5,400 cars, and 14 car rental companies within the 2 million SF campus. The construction cost was \$316 million.

The landscape theme of the RCC reflects San Diego’s unique location and significant natural features. The landscape reflects the idea of movement, which is indicative of travel as well as the surrounding natural systems of wind and water, and is recognizable from both the air and ground. Palm trees accentuate the architecture and represent major paths of travel through the site. Site appropriate plant materials were selected for drought tolerance and low maintenance, with plant material colors and textures reinforcing the theme of movement, accent, and scale. California natives. Coastal compatible plants were key to providing a balance of minimizing water use.

The project was collaboratively designed and built with sustainable strategies to achieve a LEED Silver rating. Water

is captured in seven on-site bioswales and filtered through the planting areas in compliance with regulations to seamlessly integrate the landscape design with the storm water systems and the Storm Water Pollution Prevention Plan. The treatment control BMPs include: infiltration, capture and reuse, biofiltration, and mechanical treatment.

An important goal of the project was to provide pedestrian access to the future Intermodal Transit Center by integrating pedestrian linkage into and through the RCC site. This linkage supports the San Diego regional transportation goals of encouraging the use of mass transit, minimizing airport related traffic impacts to adjacent communities and improving intermodal access to the airport and airport facilities. The themed pedestrian and vehicular concrete paving was enhanced with color, special finishes and enhancements. Also included were furnishings such as picnic tables, benches, and a dog relief area. The palm-lined 1,400-foot long fire lane along Pacific Highway serves as an attractive streetscape amenity.

Award: 2016 APWA San Diego

PARKS & RECREATION | PLANNING EXPERIENCE



Parks Master Plan	Open Space Master Plan	Trails Master Plan	Feasibility Study/Concepts	Needs Assessment/Survey	Facilities Assessment	Safe Access to Parks	Funding Strategies	Community Engagement
-------------------	------------------------	--------------------	----------------------------	-------------------------	-----------------------	----------------------	--------------------	----------------------

Agency	Project Name	Project Scope							
City of Santa Maria	Parks Master Plan								
City of Carlsbad	Trails Master Plan								
City of Corona	Trails Master Plan								
City of Encinitas	Parks Master Plan								
City of Goleta	Parks Master Plan								
City of Grover Beach	Senior Center Feasibility Study								
City of Hesperia	Parks Master Plan								
City of La Mesa	Parks Master Plan and Safe Routes to Parks								
City of La Mesa	MacArthur Park Master Plan								
City of Montebello	Parks Master Plan								
City of Oceanside	Parks Master Plan								
City of Ontario	Parks Master Plan								
City of Perris	Parks Master Plan								
City of Pico Rivera	Urban Greening Plan								
City of Placentia	Open Spaces and Urban Greening Plan								
City of San Diego	Mission Trails Regional Park Master Plan								
City of San Gabriel	Parks Master Plan								
City of Santee	Parks Master Plan								
City of Santee	Community Center Feasibility Study								
City of Signal Hill	Parks Master Plan								
City of Temecula	Multi-Use Trails and Bicycle Master Plan								
City of Walnut	Community Aquatics Feasibility Study								
City of Victorville	Parks Master Plan								
Phelan and Piñon Pines	Parks Master Plan								
County of Riverside	Box Springs Mountain Trails Master Plan								
County of Riverside	Countywide Parks Master Plan								
County of San Bernardino	Prado Regional Park Master Plan								
County of San Bernardino	Regional Parks Master Plan								
County of San Diego	Parks Master Plan								
Girl Scouts San Diego	Countywide Facilities Master Plan and CIP								
Port of San Diego	Parks Master Plan								
Rancho California WD	Vail Lake Trail & Lake Management Plans								

PARKS & RECREATION | PARKS & PLAYGROUNDS



North Ocean Beach Gateway



Alga Norte Community Park

PARK MASTER PLANS

- City of Encinitas Parks Master Plan
- City of Goleta Parks and Playgrounds Master Plan
- City of Hesperia Parks Master Plan
- City of La Mesa Parks Master Plan
- City of La Mesa MacArthur Park Master Plan
- City of Montebello Parks Master Plan
- City of Oceanside Parks Master Plan
- City of Ontario Parks Master Plan
- City of Perris Parks Master Plan
- City of San Gabriel Parks Master Plan
- City of Santa Maria Parks Master Plan
- City of Santee Parks Master Plan
- City of Signal Hill Parks Master Plan
- City of Victorville Parks Master Plan
- Communities of Phelan and Piñon Pines Parks Master Plan
- County of Riverside Parks Master Plan
- County of San Bernardino Regional Parks Master Plans
- County of San Bernardino Prado Park Master Plans
- County of San Diego Parks Master Plan
- Girl Scouts San Diego-Imperial Council Recreation Facilities Master Plan
- Port of San Diego Parks Inventory and Assessment
- Stone Creek Parks Master Plan

REGIONAL PARKS

- Camp Lockett Historic Park Framework Management Plan, Campo
- Chula Vista Bayfront Parks
- Colton Regional Park Master Plan
- Fiesta Island Park Precise Plan
- Mission Trails Regional Park Master Plan and Natural Resource Management Plan
- Murrieta Creek Recreation Basin, Temecula
- Moabi Regional Park Master Plan, & Mojave River Forks Regional Park Master Plan, San Bernardino County

COMMUNITY PARKS

- Alga Norte Community Park, Carlsbad
- Buena Vista Park Master Plan, Vista
- Carmel Valley Community Park, San Diego
- Conejo Community Park, Thousand Oaks
- MacArthur Park Opportunities and Constrains Study, La Mesa
- Mira Mesa Community Park
- Nobel Athletic Area and Library, San Diego
- Porterville Community Park
- Poway Park Master Plan Feasibility Study
- Rincon Community Park, Valley Center
- Salt Creek Community Park, Chula Vista

NEIGHBORHOOD PARKS

- 39th Street Park GDP, San Diego
- Ashley Falls Park, San Diego
- Breen Park, San Diego
- Briercrest Park Master Plan, La Mesa
- Centrum Park, San Diego
- Cabrillo Heights Park, San Diego
- Canyon Hills Resource Park, San Diego
- Collier Park, Ramona
- Dusty Rhodes, San Diego
- Lakeview Park, Discovery Hills, San Marcos
- La Mesita Park Master Plan
- Macy Neighborhood Park Improvement, San Diego
- Martin Luther King Park, San Diego
- Memorial Park ADA, San Diego
- Northmont Park, La Mesa
- Ocean View Hills Park, San Diego
- Olive Street Park, San Diego
- Rancho Mission Canyon Park, San Diego
- Sabre Springs Park, San Diego
- Sage Canyon Park, San Diego
- Southcreek Park, San Diego
- Southcrest Trail Park, San Diego
- Sunshine Berardini Park General Development Plan, San Diego
- Taft Joint Use Park, San Diego
- Torrey Highlands Park, San Diego
- Trolley Barn Park, San Diego
- Valencia Park, San Diego
- Wildwood Park, Vista

PARKS & RECREATION | AQUATIC FACILITIES & SPORTS COMPLEXES



Alga Norte Community Park

KTUA provided landscape architectural services for a new 32.1-acre park located in the City of Carlsbad. The park includes an aquatic facility with a 25-meter pool, a 56-meter Olympic/competition pool, a spa and a children's play pool. Other facilities include a community building with administrative offices, skatepark, fenced in off-leash dog areas, three ballfields with a shared multi-purpose field, basketball court, picnic and seating areas, site furnishings and parking. An expansive playground with shade canopies was designed for children of various age groups and abilities.

The park site features natural topography with 70 feet of elevation change from the highest to the lowest point, providing challenges for the design of the stormwater systems. The solutions include bioswales running along the length of the east and south perimeters of the park that cleanse the stormwater prior to discharge into the public stormwater system. The surrounding natural open spaces remain preserved and protected as a part of the city's plan, which includes an additional 10 acres of California coastal sage scrub habitat on the north and west sides of the park.

KTUA was responsible for a thorough review of the bridging documents, updating and revising the plans to comply with new federal and local regulations, and incorporating amenities per the City of Carlsbad's request.

AQUATIC FACILITIES

- Alga Norte Community Park Aquatic Center
- Carmel Valley Community Park Aquatic Center
- Encanto Park Pool Study and Park General Development Plan, San Diego
- Mission Valley YMCA Pool, San Diego
- SDSU Aquaplex, San Diego
- SeaWorld Aquatica, Chula Vista

WATERFRONT PARKS

- Coast Boulevard Park, La Jolla
- G Street Mole, San Diego
- Port of San Diego Chula Vista Bayfront Parks

SPORTS COMPLEXES

- Barnes Tennis Center, San Diego
- Cal State San Marcos Athletic Complex Master Plan
- Chargers Training Facility, San Diego
- Mission Sports Park Expansion, San Marcos
- San Diego Tennis and Racquet Club, San Diego
- SDSU ENS 700 Field, San Diego
- SDSU Softball and Tennis Complex, San Diego
- SDSU Student Field, San Diego
- UCSD North Campus Recreation Area, La Jolla
- UCSD East Campus Baseball Field, La Jolla
- USD Athletic Fields, San Diego
- USD Fowler Field and Cunningham Stadium
- USD Jenny Craig Pavilion

TRAILS, CAMPGROUNDS, OPEN SPACE & INTERPRETIVE FACILITIES

RECREATIONAL TRAILS

- Balboa Park Trails Signage and Mapping Plan, San Diego
- Bayshore Bikeway, San Diego
- Bernardo Mountain Trail Study, San Diego
- Box Springs Mountain Trails Master Plan, Riverside County
- Carlsbad Ocean Street Beach Access
- City of Costa Mesa Multi-Use Trails Master Plan
- San Diego Canyonlands Mid-City Canyons Trails
- City of Yucaipa Wildwood-Calimesa Trail Master Plan
- Coast to Crest Trail, San Dieguito Lagoon Segment, San Diego
- County of San Diego Boulder Oaks Access Plan
- Encinitas Beach Access Trails
- Heritage Trail, Valley Center
- Los Penasquitos Lagoon Public Access Plan
- Mockingbird Canyon Trail, Riverside
- Murrieta Creek Trail, Temecula
- Ocean Beach Bike Path, San Diego River
- Port of San Diego Chula Vista Bayfront Sweetwater Bicycle and Pedestrian Promenade
- Roripaugh/Johnson Ranch Trails
- Santa Ana River Parkway, Orange County

- Santa Ana River Trail, Riverside County
- Santa Ana River Trail, Phase 4, San Bernardino County
- San Diego River Trails Gap Analysis
- Sea World Bike Path, Mission Bay
- UC San Diego Coastal Meander

CAMPGROUNDS

- Daley Ranch Strategic Plan, Escondido
- Fiesta Island Youth Campground, Mission Bay, San Diego
- Kumeyaay Campground, Mission Trails Regional Park
- Santee Lakes Campground
- Moabi Regional Park Campground
- Mojave Regional Park Campground
- Vail Lake Lower Chardonnay Campground Improvements

OPEN SPACE

- San Dieguito Lagoon Restoration, San Diego
- Famosa Slough Enhancement Plan, San Diego
- Taylor Yard, Los Angeles

ARBORETUMS

- Palm Arboretum, Balboa Park, San Diego
- Palomar College Arboretum, San Marcos

INTERPRETIVE AND VISITOR CENTERS

- Agua Hedionda Learning Center Landscape Master Plan, Carlsbad
- Kumeyaay-Ipai Interpretive Center, Poway
- Leo Carrillo Ranch Park, Carlsbad
- Mission Trails Regional Park Visitor and Interpretive Center, San Diego
- Piedras Pintadas Sacred Archaeological Site, San Dieguito River Park, San Diego
- Rancho Los Cerritos Visitor Center, Long Beach

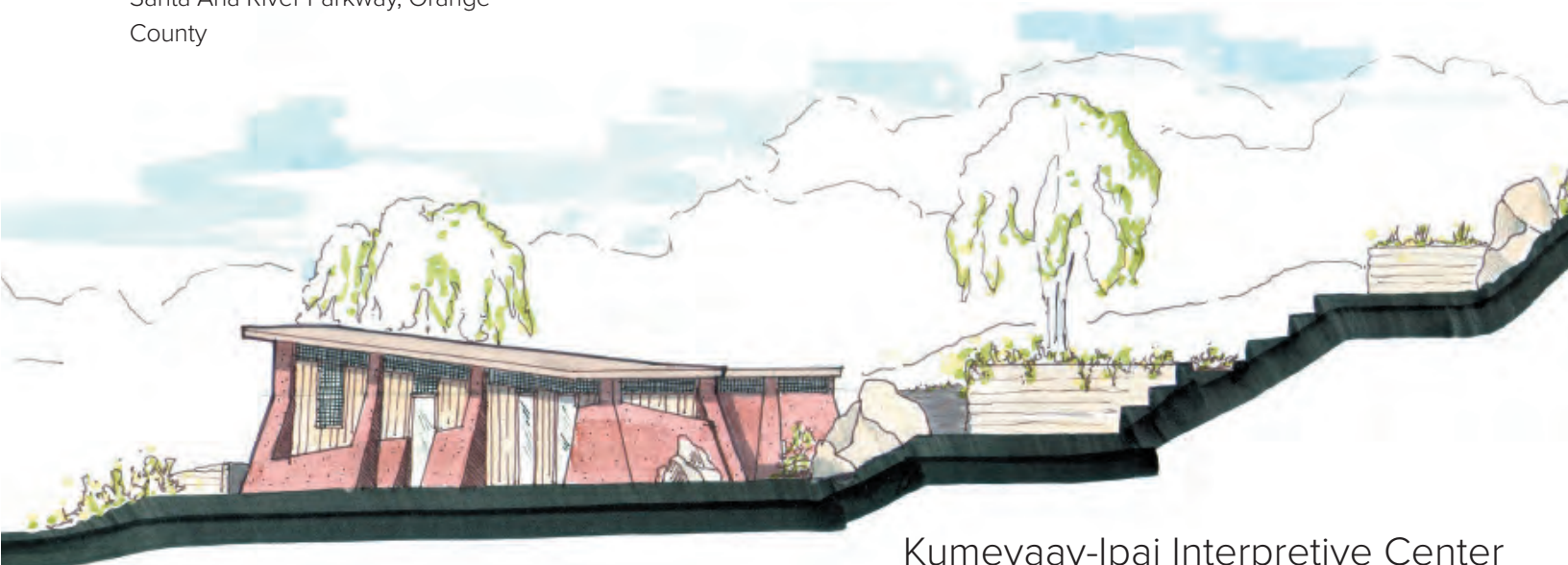

Kumeyaay-Ipai Interpretive Center

RESOURCE MANAGEMENT | MANAGEMENT & CONSERVATION PLANS

HABITAT RESTORATION

- Batiquitos Lagoon Mitigation Monitoring, Carlsbad
- Buena Vista Lagoon Restoration, Carlsbad
- Camino del Rio North, San Diego
- Crestridge Road Crossing Improvement Project, San Diego County
- El Camino del Norte Bridge, Encinitas
- Famosa Slough Enhancement Plan, San Diego
- Forester Creek, Santee
- La Jolla Bluff Restoration, La Jolla
- Malibu Creek Restoration, Malibu
- Moreno Lakeside Pipeline and Lakeside Pump Station Revegetation, Lakeside
- National City Wharf Extension Wetland Mitigation, National City
- Penasquitos Trunk Sewer, San Diego
- Port of Oakland Middle Harbor Enhancement Area,
- Roripaugh Ranch, Temecula
- Rose Canyon Mitigation, San Diego
- Rose Creek Enhancement Plan, San Diego
- San Clemente Canyon, San Diego
- San Dieguito Reservoir, Rancho Santa Fe
- San Dieguito Lagoon Wetland Restoration, San Diego
- Santa Ana River, Orange County
- Sorrento Valley Road, San Diego
- Sycamore Canyon Landfill Wetland Mitigation, San Diego
- Taylor Yard Parcel G-2 Upland Restoration, Los Angeles
- Tecolote Creek Treatment Wetlands, San Diego

RESOURCE MANAGEMENT

- San Diego River Natural Resource Management Plan, San Diego
- Coastal Sediment Benefit Analyses Tool, Ventura, Santa Barbara and San Diego Counties
- Western Otay Valley Regional Park Natural Resource Management Plan
- SANDAG Nearshore Study, San Diego
- San Clemente Island Land Use Compatibility Study
- San Diego County Water Authority Habitat Conservation Program
- UC San Diego Coastal Meander
- Western Riverside County Habitat Conservation Plan, Riverside County
- MCB Camp Pendleton Multiple Species Management Plan

WATERSHED MANAGEMENT

- Rose Creek Canyon Watershed Opportunities Assessment, San Diego
- San Diego River Watershed, San Diego
- Calleguas Creek Watershed, Ventura
- Carlsbad Watershed, Carlsbad
- Santa Margarita Watershed, Escondido
- San Diego Integrated Regional Water Management Plan

STORMWATER/LID

- UCSD Scripps Institution of Oceanography Water Pollution Prevention Program, La Jolla

FIRE MANAGEMENT

- Crest Canyon Fire Management Plan, Del Mar
- San Vicente Area Specific Management Plan, San Diego County
- Rancho Santa Fe Fire Department GIS Support Services, Rancho Santa Fe

LEED/SUSTAINABILITY

- CRES Facility, San Diego Wild Animal Park, San Diego
- Nobel Athletic Area and Library, San Diego
- UCSD Health Sciences Graduate Student Housing, La Jolla
- UC Merced Gardenview Student Housing, Merced
- Marine Corps Base Camp Pendleton Replacement Hospital, Camp Pendleton

WATER CONSERVATION

- Los Angeles National Cemetery Irrigation Feasibility Study, Los Angeles
- Naval Medical Center Water Conservation Study, San Diego
- Water Efficient Landscape Conversion, Nellis Air Force Base, Nevada
- Calsense Irrigation Retrofit at Military Housing Sites, San Diego
- Marine Corps Recruit Depot Grounds Development Study, San Diego
- Landscape Irrigation Water Conservation Policies and Guidelines, Navy and Marine Corps Facilities, San Diego



Simulation of La Jolla Bluff Restoration

VISUAL SIMULATIONS

- Lake Hodges Bike/Pedestrian Bridge
- San Diego Convention Hotel Visual Simulations
- Otay Reservoir Visual Simulations, San Diego
- Washington Street Improvements Visual Simulations, San Diego
- Whitesgate Reservoir Visual Simulation, Riverside

VISUAL STUDIES

- Aldine Drive, San Diego
- Agua Hedionda Pump Station, Carlsbad
- Beacons Beach Trail and Slope Restoration, Encinitas
- Bear Valley Parkway Widening, Escondido
- Carmel Valley Road Enhancements
- Chula Vista Bayfront Master Plan
- El Camino Real Bridge Widening, San Diego
- Entrada Office Building, Culver City
-

- Foothill Transportation Corridor South, Orange County
- French Valley Parkway, Temecula
- Interstate 805/Orange Avenue Interchange Widening Visual Impact Assessment, Chula Vista
- Mid-Coast Light Rail Corridor, San Diego
- Museum of Tolerance Expansion, Los Angeles
- Otay Landfill Expansion, Chula Vista
- Miramar Landfill General Development Plan EIR
- San Diego Convention Center Expansion
- San Diego County Water Authority Emergency Storage Project
- UCSD Interstate 5 High Technology Bridge Visual Impact Assessment
- UCSD Medical Center Utility Bridge
- Welk Village Expansion, Escondido
- Willow Street Bridge Replacement Visual Simulations, Impact Assessment and Habitat Restoration, Chula Vista

HISTORIC RESOURCES

- Camp Lockett Framework Management Plan, San Diego County
- La Jolla Cultural Resource Survey
- Naval Training Center Historic District Landscape Design Guidelines, San Diego
- Old Town, San Diego
- Leo Carrillo Ranch Historic Park, Carlsbad
- Rancho Los Cerritos, Long Beach
- Kumeyaay-Ipai Interpretive Center, Poway
- Marine Corps Recruit Depot Historic District Landscape Master Plan and Base Exterior Architecture Plan, San Diego
- NSA Monterey Roman Pool Alternatives Analysis Study, Monterey
- Naval Station Great Lakes Base Exterior Architecture Plan, Illinois
- Naval Air Station Pensacola Base Exterior Architecture Plan, Florida

HOSPITALITY | HOTELS, RESORTS, THEME PARKS & GOLF COURSES



Grand Del Mar

HOTELS AND RESORTS

- Grand Del Mar, Del Mar
- Grand Hyatt Patio, San Diego
- Harbor Island Hotel Concept Plans, San Diego
- Inns at Buena Vista Creek, Oceanside
- Kona Kai Club Conceptual Plans, Shelter Island, San Diego
- La Casa del Zorro, Borrego Springs
- Le Meridien Resort Hotel, Coronado
- Liberty Station Hotels, San Diego
- Manchester Pacific Gateway Hotel, San Diego
- Pacific Terrace Inn, San Diego
- Pala Mesa Resort Renovations, Pala
- Rancho Bernardo Hilton Garden Inn
- Rancho Bernardo Inn Renovations
- Westgate Hotel Renovation, San Diego
- Yuma Waterfront Hotel and Conference Center Concept Plans, Yuma, AZ

CASINOS

- Desert Diamond Casino, Tucson
- Hawaiian Gardens Casino Conceptual Plans, Hawaiian Gardens

ZOOS AND THEME PARKS

San Diego Zoo

- Hippo Beach
- Polar Bear Plunge
- Children's Zoo Charrettes

San Diego Zoo Safari Park

- Center for the Reproduction of Endangered Species
- Heart of Africa

SeaWorld San Diego

- Harborside Cafe
- Electric Eel
- Explorer Shore and Restroom
- Flamingo Exhibit
- Ocean Explorer
- Park Entry and Main Entry Irrigation
- South Shores Promenade
- Tidal Twister

Aquatica Water Park, Chula Vista

- Hooroo Run
- Park Renovation
- Water Slide

GOLF COURSES AND CLUBHOUSES

- Balboa Park Golf Course Clubhouse Master Plan, San Diego
- Barnes Tennis Center, San Diego
- Copper River Clubhouse, Fresno
- Del Mar Country Club Estates, Rancho Santa Fe
- El Camino Country Club Clubhouse, Oceanside
- Maderas Country Club Clubhouse, Poway
- San Diego Tennis and Racquet Club, San Diego
- The Crossings at Carlsbad
- The Vineyard Clubhouse, Escondido
- Torrey Pines Golf Course Clubhouse Renovations, San Diego
- Torrey Pines North Course Reconstruction, San Diego

RESTAURANTS

- Coasterra 880 Harbor Island



Liberty Station Hotels and Promenade - NTC Hotels

KTUA provided full services to The Corky McMillin Companies and InterMountain Management LLC to develop a 650-room, three-brand hotel destination at Liberty Station, San Diego. The new hotel development at Liberty Station consists of a 181-room Hampton Inn and Suites by Hilton, a 222-room TownePlace Suites by Marriott, and a 247-room Embassy Suites by Hilton. The project also includes a one-story, 3,180-square-foot restaurant. The three brands are complementary and form a synergistic urban destination to serve business travelers, leisure visitors and airport 'short stay' guests. Each hotel features a uniquely branded design theme that is woven into the master site design.

The plan calls for 701 parking spaces including 15 coastal access spaces, traffic improvements to nearby Kincaid Road, a pedestrian connection to Spanish Landing Park, and 22,000 yards of balanced grading.

KTUA supervised the successful approval process with the California Coastal Commission, resulting in overall project approval including a major 150-foot-wide public esplanade with active/passive recreation areas, a pedestrian/bicycle path and public seating. The promenade includes

several landscaped bio-retention basins to collect, treat, and discharge storm water collected from impervious surfaces including parking lots and building roofs. The basins were designed to ensure proper capacity and integrated thoughtfully into the landscape aesthetic. Due to a high saltwater table from the adjacent San Diego Bay, plant species were carefully selected for the basins that would tolerate occasional exposure to salt and brackish water. KTUA facilitated permitting drawings with the City of San Diego, and provided construction administration services.



HOUSING | SINGLE-FAMILY, MULTI-FAMILY AND MIXED USE

NEW COMMUNITIES

- Carmel Country Highlands, San Diego
- Carmel Valley, San Diego
- Castlerock, San Diego
- Discovery Hills, San Marcos
- Lusk Patio Homes, San Diego
- Ocean View Hills, San Diego
- Sabre Springs, San Diego
- Stone Creek, San Diego

MULTI-FAMILY AND MIXED USE

- 55th Street Village, San Diego
- 600 Front, San Diego
- Alba Gardens, Chula Vista
- Allegro Towers, San Diego
- Arcadia Apartments, San Diego
- Columbia Square, San Diego
- Delano Grapevine Apartments, Delano
- First & Maple Apartments, San Diego
- Hamilton Row, San Diego
- La Mirage Apartments, San Diego
- Marina Park, San Diego
- Market Street Square, San Diego
- Nobel Creek Apartments, San Diego
- Oro Vista Apartments, San Diego
- Pacifica Chula Vista Bayfront (Amara)
- Park Row, San Diego
- River Run Apartments, San Diego
- Union Tribune Mission Valley, San Diego

MODEL HOMES

- Alta Murrieta, Temecula
- Aragon, Rancho del Rey, Chula Vista
- Mar Lado, Pepper Tree, Oceanside
- Mar Luna, Chula Vista
- Rustler's Ranch, Palmdale, Moreno Valley, Sun City
- The Trails, Discovery Hills, San Marcos
- Woodridge, Irvine

AFFORDABLE HOUSING

- Eden Housing, Ontario
- Logan Avenue Housing, San Diego
- Maya Linda Apartments Renovation, San Diego
- Old Grove Apartments, Oceanside

HOUSING REINVESTMENT

- La Mirage, San Diego
- Solazzo, San Diego
- Westwood, San Diego

COMMON AREA RESTORATION

- Lomas Santa Fe Country Club Villas Landscape and Irrigation Assessment, Solana Beach
- Park Row, San Diego
- Sycamore Creek, Poway

SINGLE FAMILY HOUSING

- Bonsall
- Cardiff
- Coronado
- Del Mar
- Fairbanks Ranch
- France
- Julian
- La Jolla
- La Quinta
- Las Vegas
- Pauma Valley
- Point Loma
- Rancho Bernardo
- Rancho Santa Fe
- San Diego
- Scripps Ranch
- Solana Beach
- Stockton
- Tijuana, Baja California
- Valley Center





Amara Bay by Pacifica

The Amara Bay Community master plan envisions a world-class destination for people to live, work and play. Among the three development districts that compose the Chula Vista Bayfront, KTUA is working with Pacifica on the Harbor District, planned for 5,049,500 sf of mixed use development. The district includes various parks, plazas, seven new streets, a Class II bikeway, “woonerf” inspired pedestrian promenades, and other amenities designed to encourage pedestrian and bike mobility throughout the waterfront community. KTUA prepared landscape design guidelines for the entire development.

KTUA’s first project is a 4.5 acre site designed to be the gateway of the community. The project includes three buildings ranging from the main 14-story residential tower to a four-story condominium building and three-story mixed use building on Marina Parkway. The 14-story residential tower will include a restaurant, spa, fitness center and other public amenities on the first floor. The interior court features a refined contemporary landscape expressing the waterfront experience in modern, clean forms, and accented by public art, exhibit garden areas, a public fire place, and various relaxing seating areas.

At the eastern edge of the site, KTUA is working on the main gateway park that serves as the entry portal for the community and includes various amenities such as a public open lawn, public art features, woonerf walkway with seating areas, a stage and amphitheater, playground, a splash pad, and a natural water feature. Along the perimeter of the site, KTUA is working closely with the civil engineer to establish an informal walkway system allowing for maximum stormwater infiltration and flow, and a seamless connection to the podium level of the buildings for fire, pedestrian and visual access.

In preparation for the first phase tower, KTUA is currently preparing full streetscape construction documents associated with J-Street, Chula



Vista. The work includes coordination with the Port of San Diego, the City of Chula Vista, Caltrans, and Pacifica. The scope of work includes the first major roadway thematic planting and entry statement leading to the project, interface and partial reconstruction of Marina Park, and new streetscape along Marina Parkway. The streetscape features planting unique to the project, adapted to the coastal environment, and functional bioretention areas.



La Mirage Apartment Complex

The 1,400 unit La Mirage apartment complex was built in the 1990s on a 70-acre site above Mission Valley and Interstate 15. Irvine Company purchased the property, rebranded it to The Village at Mission Valley, and completed a \$150 million luxury apartment complex transformation in an aggressive time frame.

KTUA was one of three landscape architects invited to collaborate on the project. KTUA's scope included four villages consisting of multiple buildings and parking lots, podiums, courtyards, a perimeter trail system, two fenced dog parks with agility equipment and benches, two enclosed pool areas and the perimeter slopes on Friars and Santos Road. Sketches and visualizations were prepared during the design phase to assist in presentations.

Design and development of bid plans was the most critical task. Since there were no base sheets or as-built information available, KTUA conducted multiple site visits to prepare an extensive planting and irrigation site inventory. Base sheets were created from civil survey drawings, Google Earth and field verification. The project was large, therefore, three teams were formed within KTUA to complete the plans within the short time frame. Plans

included demolition, palm tree relocation exhibits, street tree plans, construction plans and details (inclusive of pool redesign and upgrades, podium planter reconfigurations and details, waterproofing, paving, podium artwork, site furnishings, dog park layouts and associated components, banners, d.g. trail, fencing, etc.), planting and irrigation plans, and specifications.

KTUA provided site assessment of existing irrigation systems and feasibility review for new irrigation design and installation with existing site improvements to be protected in place including existing established plants. Challenges were keeping within tight hydraulic constraints, watering windows, and construction phasing. Perimeter slope irrigation was contractor design-built with KTUA specifying water supply and controls. Efforts required close coordination with multiple consultants and contractors involved with each project phase.

KTUA prepared bid schedules, attended weekly construction meetings, and site walks (sometimes conducted daily to ensure that the work was being installed per plan). KTUA conducted preliminary and final site walks for all phases.

DESERT COMMUNITIES



La Casa Del Zorro Resort

Desert Community Projects

- La Casa Del Zorro Resort, Borrego Springs, CA
- City of Palmdale Sam Yellen and Arnie Quinones Parks, Palmdale, CA
- Palmdale Regional Medical Center, Palmdale CA
- The Crest, Palm Desert, CA
- Southern California Veterans Home, Barstow CA
- Warner Springs Ranch Resort Landscape Guidelines and Concepts, Warner Springs, CA
- U.S. Post Office, Desert Hot Springs, CA
- Mojave River Forks Regional Park Master Plan, Needles, CA
- Towncenter Court Apartments, El Centro, CA
- City of Desert Hot Springs Bicycle and Pedestrian Master Plan, Desert Hot Springs, CA
- Interstate 8/Dogwood Interchange, El Centro, CA
- Edwards AFB Child Care Facility, Palmdale, CA
- SOF Desert Training Facility, Niland (Brawley), CA
- MCB Barstow Child Care Facility, Barstow, CA
- MCB Barstow Comprehensive Neighborhood Plan, Barstow, CA
- MCAGCC Twentynine Palms Recreation Center, Twentynine Palms, CA
- MCAS Yuma Base Exterior Architecture Plan, Yuma, AZ
- Desert Diamond Casino, Tucson, AZ
- McDowell Road Streetscape, Phoenix AZ



Interstate 8/Dogwood Interchange

FEDERAL PLANNING | MASTER PLANS AND MILCONS

For more than three decades, KTUA has worked with the federal government to provide comprehensive planning solutions for our men and women in uniform. KTUA's federal planning team uses its extensive experience and specialized knowledge to fulfill today's military mission and tomorrow's needs. Our emphasis on keeping pace with rapid technological change and shifting mission priorities of the military has allowed us to achieve success across a broad spectrum of federal planning support services.

KTUA has master planning and design experience with the Navy and the Marine Corps, providing services for more than 200 planning and military construction projects in the Southwest region, Southeast region, throughout the United States, and into Europe.

PROJECT EXPERIENCE

KTUA has managed the following IDIQ contracts for planning and design services:

- NAVFAC SE Planning IDIQ, 2015
- NAVFAC SW Planning IDIQ, 2014
- NAVFAC SW Landscape Architecture IDIQ, 2011
- NAVFAC SW MILCON Planning IDIQ, 2008
- NAVFAC SW MILCON Planning IDIQ, 2006
- NAVFAC SW Landscape Architecture IDIQ, 2003
- ACOE Los Angeles District Landscape Architecture IDIQ, 2001
- NAVFAC South Planning IDIQ, 2000/2001
- NAVFAC SW Planning IDIQ, 1998
- NAVFAC SW Bachelor/Family Housing Comprehensive Neighborhood Plan IDIQ, 1995

SCOPE OF WORK

- MILCON Planning and Design
- Activity Overview Plans
- Capital Improvement Plans
- Encroachment Action Plans
- Shore Infrastructure Plans
- Functional Plans
- Installation Appearance Plans/Base Exterior Architecture Plans
- Master Plans
- Community Plans
- Asset Evaluations
- Comprehensive Neighborhood Plans
- Bachelor and Family Housing
- Special Studies
- Space Utilization Plans
- Basic Facility Requirements
- Design/Build Projects
- Request for Proposals

PROJECT LOCATIONS

- Anti-Submarine Warfare, San Diego
- Camp Atterbury
- Camp Billy Machen
- Camp Michael Monsoor
- Camp Morena, San Diego
- Chocolate Mountains Aerial Gunnery Range
- Eglin Air Force Base
- Fort A.P. Hill
- Fort Chaffee
- Fort Hunter Liggett
- Fort Irwin
- Fort Pickett
- JEB Little Creek/Fort Story
- Joint Base Pearl Harbor/Hickam, HI
- MAGTFTC MCAGCC Twentynine Palms
- Marine Corps Recruit Depot, San Diego
- MCAS Miramar
- MCAS Yuma
- MCB Barstow
- MCB/MCAS Camp Pendleton
- MCMWTC Bridgeport

- NAB Coronado
- NAWS China Lake
- NAS Corpus Christi
- NAS El Centro
- NAS JRB New Orleans
- NAS Pensacola
- Naval Base Coronado
- Naval Base Point Loma
- Naval Base Ventura County
- Naval Base Kitsap
- Naval Construction Battalion Center Gulfport
- Naval Hospital Beaufort South Carolina
- Naval Medical Center San Diego
- Naval Station Great Lakes
- Naval Base San Diego
- Naval Training Center San Diego
- NAVFAC Europe, Naples Italy
- Navy Region South
- Navy Region Southwest
- Navy Support Activity New Orleans
- Nellis Air Force Base
- NSB Kings Bay
- NSCS Athens
- NSU Saratoga Springs
- NSWC Indian Head
- NWS Seal Beach
- San Clemente Island
- Space and Navy Warfare Systems Center San Diego
- Stennis Space Center
- U.S. Coast Guard San Diego



Manchester Pacific Gateway | NAVFAC - U.S. Navy Headquarters

Designing and constructing a secure General Administration Facility (GAF) in the heart of an urban downtown core presented a multitude of design challenges. At the fore front were AFTP (Anti-Terrorism Force Protection) measures to provide building perimeter security. KTUA collaborated with the project architects and NAVFAC staff to develop a site landscape design that seamlessly integrated security measures such as K12 bollards and barrier walls into the landscape design to strike a sensitive balance between security and creating an inviting, plaza space accessible to the public. In addition to integration of physical barriers, other AFTP principles such as clear sight lines and prevention of concealment of small packages were also key features of the landscape design. Due to the public/private nature of this development, NAVFAC design standards were considered and adhered to, to the fullest extent possible.

The entire site was constructed over a two-level parking garage. This podium condition presented the design

team with a host of utility and structural design considerations. KTUA coordinated with the project's structural engineers, mechanical, electrical, and plumbing engineers, civil engineers, and the project architects to work through the difficult orchestration of landscape and AFTP features, tree installations, structural limitations, and extensive utility coordination through the structure.

The design and coordination effort was made possible by implementation of design and collaboration technology to keep the very large design team in constant communication. AutoCAD / REVIT formed the foundation of the design. Collaboration without face to face meetings was possible with the use of GoTo meetings and the use of Bluebeam software. The project site and off-site improvements are consistent with the 1992 Navy Broadway Agreement, Civic San Diego Streetscape Design Guidelines and the North Embarcadero Visionary Plan.

MCAS Yuma Dining Hall



The project utilized a highly efficient, automatic irrigation system that provides a subsurface drip irrigation method to each shrub, succulent and groundcover, with the irrigated area limited to within the root zones of the plants.

The irrigation system is controlled electrically with a satellite irrigation control system and communicates with the Base's irrigation central control system. The irrigation system included design elements and equipment to minimize damage to key components, such as sprinkler heads, controllers, control valves, valve boxes and the backflow preventer.

The MCAS Yuma project has a 150,000-gallon irrigation water parameter. The planting design along with the efficient irrigation system design will stay below that parameter and after four years post installation the Irrigation system will be reduced to 39,159 gallons per year.

The scope of the landscape design included elements to make the outdoor environment more sustainable, comfortable, pleasant and safe, achieve AT/FP setbacks, screen unattractive uses, provide wind protection and a variety of shade methods for relief from extreme heat. These included landscape and rock mulches for erosion control, drought tolerant/native containerized planting for the building entry, plaza, perimeter/interior and streetscape landscape.

PLANNING | LAND USE | URBAN PLANNING

SPECIFIC PLANS

- City of National City Downtown Specific Plan
- Downtown Manhattan Beach Specific Plan Mobility Guidelines

COMMUNITY PLANS

- North Park Community Plan Update
- Uptown Community Plan Update Mobility Element, San Diego

COMMUNITY CHARACTER STUDIES

- City of Encinitas Hymettus Estates
- City of Encinitas Requezia

MASTER PLANS

- El Corozon de Oceanside Master Plan
- Girl Scout Facilities Master Plan, San Diego County
- Father Joe's Children's Village, Campo
- Rancho San Vicente, Campo

HEALTHY COMMUNITY PLANS

- City Heights Urban Greening Plan
- Jacobs Center for Neighborhood Innovation Community Health & Wellness Element
- La Mesa Safe Routes to Transit and Parks Plan
- Pico Rivera Urban Greening Plan

URBAN PUBLIC SPACES

- Lincoln Avenue Community Avenue and Pedestrian Connection, San Diego
- Mid-City Transit Gateway, San Diego
- North Ocean Beach Gateway, San Diego

SMART GROWTH/TOD

- Main Street Promenade, Lemon Grove
- 8th Street Corridor Smart Growth Project, National City
- C Street Master Plan, San Diego
- North County Transit District Land Use Studies, Oceanside, Carlsbad, Escondido
- University Towne Center Transit Station Urban Design Study, San Diego
- SANDAG Parking and Trip Generation Rate Assessments, San Diego
- SANDAG Smart Growth Design Guidelines, San Diego

WAYFINDING/SIGNAGE

- Cal State San Marcos Campus Wayfinding and ADA Accessibility
- City of Commerce Gateway and Wayfinding Signage
- CCDC Downtown Signage Master Plan, San Diego

MIXED USE URBAN INFILL

- Linda Vista Redevelopment, San Diego
- Jacobs Center/Market Creek Plaza Urban Studies, San Diego
- Downtown Porterville Redevelopment

- Downtown Delano Redevelopment
- Tulare Redevelopment
- Yuma Waterfront Development
- North Park Library Concept Plans, San Diego

NEIGHBORHOOD STUDIES

- The Boulevard West End - El Cajon Boulevard Traffic Calming and Pedestrian Environment Enhancement Study, San Diego
- University Avenue North Park Traffic Calming Study, San Diego
- Hillcrest Parking Study, San Diego
- Uptown Traffic Calming Study, San Diego

DESIGN GUIDELINES

- Stone Creek, San Diego
- Adams Avenue Design Guidelines, San Diego
- Mission Hills Business District Design Guidelines, San Diego
- Naval Training Center Historic District Landscape Design Guidelines, San Diego
- Naval Air Station Pensacola Base Exterior Architecture Plan
- Naval Station Great Lakes Base Exterior Architecture Plan, Waukegan, IL
- MCAS Yuma Base Exterior Architecture Plan
- MCAGCC Twentynine Palms Base Exterior Architecture Plan
- MCB Camp Pendleton Base Exterior Architecture Plan
- NCBC Gulfport Installation Appearance Plan



City of National City Downtown Specific Plan



The City of National City received a smart growth grant from SANDAG for their Downtown Specific Plan (DSP) to update development and parking standards within the district. Key objectives included positioning Downtown National City to capitalize on resurgent real estate and employment markets by making the plan more user-friendly, allowing a greater range/mix of uses, and increasing the quality of design through updated design guidelines. KTUA and its team of subconsultants produced materials related to the promotion of former redevelopment agency properties, the assessment of parking assets and programs/policies, the existing DSP/application processing review, public outreach and workshop facilitation, urban form modeling and visualizations, update of the DSP and the creation of a parking management plan, environmental conformance review, and the presentation of the plan to City staff and elected officials.

One section of design guidelines chapter focuses on recommendations for the public realm, including all spaces within the right-of-way encompassing sidewalks, parkways, bike lanes and roadways. Specific topics addressed include street typologies, public on-street parking, stormwater basins and infrastructure, bicycle facilities, pedestrian facilities, street amenities, signage, public art and street tree palettes.

“ We look forward to implementing the plan and creating public and private projects that add to the vibrancy of our downtown.

– BRAD RAULSTON, CITY OF NATIONAL CITY, DEPUTY CITY MANAGER

PLANNING | TRANSPORTATION PLANNING



City of San Diego
Talmadge Traffic Calming Feasibility Study

LIVABLE STREETS AND EQUITABLE TRANSPORTATION OPTIONS

At the heart of every successful community is an integrated network of livable streets that provide connectivity and improve livability in a community. More than 80% of all public spaces in cities are streets, and the elements of these streets, from sidewalks to travel lanes to transit stops, all vie for space within this limited right-of-way. An integrated transportation network reduces land consumption, provides greater accessibility through more direct routes and increases overall network efficiency and reliability through added redundancy. As a result, sustainable community goals are achieved through efficient travel patterns, increased road safety and improved public health.

The physical and social health of our communities requires a design approach sensitive to the multi-faceted and ever-changing role streets play in our cities. KTUA explores ways to make the most of the right-of-way and enhance the public realm. Activated public plazas and linear parks, highly visible pedestrian and bicycle amenities, accessible transit options and transportation hubs, safe routes to schools, parks and community amenities, and green infrastructure to address water management are some of the efficient uses of valuable street space. KTUA takes a proactive approach to design to create positive results through the use of physical and environmental cues and to promote equitable transportation options..

PLANNING | TRANSPORTATION PLANNING

ACTIVE TRANSPORTATION | SAFE ROUTES | VISION ZERO PLANS

- City of Artesia ATP
- City of Barstow ATP
- Cities of Bellflower and Paramount ATP
- City of Colton ATP
- City of Chino Bicycle and Pedestrian Master Plan
- City of Desert Hot Springs Bicycle and Pedestrian Master Plan
- City of Eastvale Bicycle Master Plan
- City of El Centro ATP
- City of Encinitas ATP
- City of Grand Terrace ATP
- City of Jurupa Valley ATP
- City of Irvine ATP
- City of Los Alamitos ATP
- City of Menifee ATP
- City of Paso Robles ATP
- City of Rialto ATP
- City of San Jacinto ATP
- City of Santa Ana ATP
- City of Temecula Multi-use Trails and Bicycle Plan
- City of Thousand Oaks ATP
- County of Imperial ATP
- County of San Bernardino Safe Routes to School
- City of San Diego Vision Zero
- County of San Diego Bicycle Master Plan
- County of Ventura Transportation Plan
- HUD Guidelines for Walkable and Bikeable Communities
- OCTA Active Transportation Plan
- Soboba Reservation ATP

CAMPUS CIRCULATION STUDIES

- San Diego State University Bicycle and Skateboard Master Plan
- Cal State San Marcos Wayfinding and ADA Transition Plan
- UC San Diego Bicycle and Pedestrian Master Plan
- Orange Coast College Bicycle and Skateboard Master Plan
- UC Santa Barbara Circulation Element

COMPLETE STREETS AND CORRIDOR PLANS

- City of Atascadero El Camino Real Complete Street
- City of Chula Vista Main Street Complete Street Plan
- City of Del Mar Camino Del Mar Corridor Study
- City of Grand Terrace Michigan Street Complete Street Plan
- City of Grand Terrace Barton Road Streetscape Plan
- City of Imperial Beach Palm Avenue
- City of Lemon Grove CONNECT Main Street
- City of Lemon Grove Main Street Promenade Smart Growth Project
- City of Moreno Valley Dracaea Neighborhood Greenway Study
- City of National City 8th Street Corridor Smart Growth Project
- City of Ontario Holt Boulevard Complete Street Plan
- City of San Diego Morena Boulevard Station Area Plan
- City of San Marcos Armorlite Drive Complete Street Plan
- City of San Marcos San Marcos Boulevard Complete Street Plan
- City of Santa Ana Central Area Complete Streets Plan
- City of Santa Ana Downtown Zone Complete Streets Plan
- City of Vista Emerald and Townsite Drive Complete Streets Plan
- Civic San Diego C Street Master Plan, San Diego
- Re-Imagine Normal Street

URBAN GREENING PLANS

- City of Pico Rivera Urban Greening Plan
- City of Placentia Open Spaces and Urban Greening Plan

MOBILITY HUBS

- City of Hemet Mobility Hub
- Riverside Transit Agency Vine Street Mobility Hub

TRAFFIC CALMING STUDIES

- City of Fullerton East Wilshire Bike Boulevard
- City of Imperial Beach Traffic Calming and Bikeway Study
- City of National City Westside Traffic Calming Project
- City of San Diego Talmadge Traffic Calming Plan
- City of San Diego University Avenue North Park Traffic Calming Study
- City of San Diego Uptown Traffic Calming Plan (Fourth, Fifth, and Sixth Avenues)

TRAILS | PUBLIC ACCESS

- California Coastal Commission Hollister Ranch Public Access Plan
- City of Corona Trails Master Plan
- City of Costa Mesa Multi-use Trails Master Plan
- City of La Mesa Urban Trails Mobility Action Plan
- City of San Diego Mission Trails Regional Park Master Plan
- Cities of Wildwood and Calimesa Trails Master Plan
- County of San Diego Boulder Oaks Public Access Plan
- County of San Diego Sweetwater Bike Park
- Riverside County OHV Study
- Riverside County Santa Ana River Trail
- SBCAG Santa Ynez Trail Alignment Study

CIRCULATION STUDIES

- City of Covina First and Last Mile Study
- City of Del Mar Circulation Element Update
- City of La Mesa Transportation Element
- Naval Base San Diego Transportation Plan
- Riverside Transit Agency First and Last Mile Mobility Plan

PLANNING | TRANSPORTATION PLANNING

TRANSIT PLANNING | TRANSPORTATION DEMAND MANAGEMENT

- Commuter Behavior Baseline Survey and Gamification Research
- Integrating TDM Development Process- Training
- San Diego Forward: The Regional Plan 2013 Survey
- SD Regional Vanpool/Carpool Program
- Telework Implementation Pilot Project
- Transit Plans and Corridors
- City of San Diego Mid-City Transit Gateway
- SANDAG Mid-Coast LRT
- SANDAG Mission Valley LRT, Transit Stations and Patron Access Study
- SANDAG Old Town LRT and Transit Center and Stations
- NCTD Station Redevelopment Plans, Oceanside, Carlsbad and Escondido
- SANDAG I-805 and 47th Street LRT / BRT Station Area Plan
- SANDAG Mid-City Bus Rapid Transit Plan
- SANDAG Mid-Coast Corridor LRT and Transit Stations
- SANDAG SDSU to Downtown Bus Rapid Transit Study
- SANDAG Pacific Beach Line Concept
- SANDAG UCSD Gilman Drive Transit Center Concept Study
- SANDAG University Town Center Super Loop Transit Study
- SANDAG University Town Center Transit Center Concept Studies

PARKING STUDIES

- City of San Diego Uptown Parking Study
- MCAS Yuma Circulation and Parking Study, Yuma, AZ
- Naval Station Great Lakes Traffic, Circulation and Parking Study, Waukegan, IL
- Port of San Diego Barrio Logan Parking Study

HIGHWAY DESIGN

- Caltrans Landscape Architectural Services, District 11, San Diego
- Interstate 5/Palomar Airport Road Interchange, Carlsbad
- Interstate 805/La Jolla Village Drive Interchange, San Diego
- Orange Avenue, Olympic Parkway and Interstate 805 Interchanges, Chula Vista State Route 125, La Mesa
- State Route 163/Clairemont Mesa Blvd. Interchange, San Diego
- State Route 168, Fresno County
- State Route 56/Camino del Sur Interchange, San Diego
- State Route 76, Oceanside

URBAN REDEVELOPMENT

- Downtown Delano Streetscape Improvements, Delano
- Downtown Porterville Streetscape Improvements, Porterville
- Downtown Tulare Streetscape Improvements, Tulare
- Gaslamp Quarter, San Diego
- Shelter Island, San Diego

STREET DESIGN

- Ardath Road Realignment, La Jolla
- Armada Drive, Carlsbad
- Ballpark Infrastructure, San Diego
- Camino del Mar, Del Mar
- Cannon Road, Carlsbad
- Carmel Country Road, Carmel Mountain Road and Del Mar Heights Road, San Diego
- Carmel Valley Road, San Diego
- Discovery Hills Streetscape Improvements, San Marcos
- El Camino Real Widening, Carlsbad
- Genesee Avenue Widening, San Diego
- Hazard Center Drive, San Diego
- Lindbergh Field Improvement Plans, San Diego
- McDowell Road, Phoenix, AZ
- Mission Road Widening, Fallbrook
- Ocean View Hills Community, San Diego
- Old Coach Road, Poway
- Park Boulevard, San Diego
- Science Center Drive, La Jolla
- Sorrento Valley Road Closure Study, San Diego
- Valley Center Median, Valley Center

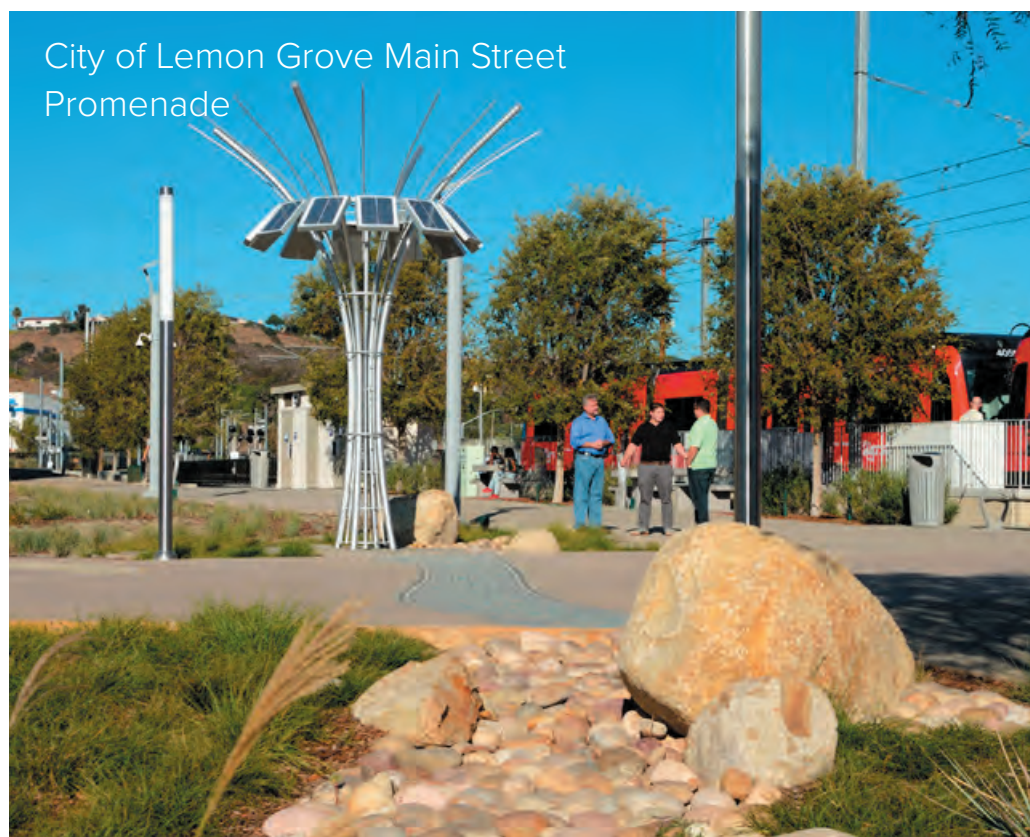



Mid-City Transit Gateway

SUPPORT SERVICES | GRANT WRITING & MANAGEMENT

Obtaining funding for planning studies and capital projects comes from thoughtfully designing and visioning the project to address the criteria of available grants. Projects that have been designed to offer multiple benefits and sustainable solutions for the requesting agency and the affected community are more likely to receive funding.

KTUA maintains a database of available grants and assists public agencies, non-profit groups, and community-based organizations in identifying grants and preparing applications to obtain grant-based funding. Services offered by KTUA include research, grant writing, project justification, mapping, and graphic support along with the development of project alternatives, schedules, and cost estimates. Grants have successfully been obtained from Caltrans, the Strategic Growth Council, SANDAG, and the California Coastal Conservancy for projects throughout Southern California. KTUA's capabilities include writing the entire grant to providing services such as mapping and graphic support for our clients.

KTUA's experience in providing grant writing support has resulted in on-call contracts with cities such as Encinitas, National City, Grand Terrace, and agencies such as Western Riverside Council of Governments and Orange County Transportation Authority.



KTUA UNDERSTANDS GRANT PROGRAMS

Based on a grant prepared by KTUA, the City of Escondido received funding for the Escondido Creek Trail from California State Parks Prop 68 - one of 62 projects funded (out of 478 applications) in the \$250M program and one of only 9 to receive the maximum \$8.5M award. February 2020.

FINDING, FRAMING AND FUNDING A PROJECT - Database of funding sources maintained by KTUA for transportation, smart growth, transit, park and resource based projects

FUNDING USES →											
FUNDING SOURCE	FUNDING ORIGIN	FUNDING CYCLE	CIP DEVELOP	MAINT & OPS	IMPLEMENTATION	FIRST & LAST MILE	URBAN FORESTRY	BACK TO NATURE	LOW IMPACT DEVELOP	CULTURE HISTORY ART	HEALTH
FEDERAL FUNDING SOURCES											
Land and Water Conservation Fund (LCWF)	U.S. National Park Service/ California Department of Parks and Recreation	December - January	✓					✓	✓		
Urban Community Forestry Program	U.S. National Park Service	September - November	✓				✓				
Surface Transportation Program (STP)	Federal Highway Administration (FHWA)/Caltrans	June	✓		✓	✓			✓		
Highway Safety Improvement Program (HSIP)		Unavailable	✓		✓	✓			✓		
Transportation Alternatives Program (TAP)		Annual	✓		✓	✓			✓		
Recreational Trails Program	Federal Highway Administration (FHWA)/Regional agency may also contribute	Annual	✓		✓	✓		✓	✓		✓
EPA Brownfields Clean Up and Assessments	U.S. Environmental Protection Agency	November - January	✓		✓	✓			✓		
Sustainable Communities Planning Grant and Incentive Program	U.S. Department of Housing and Urban Development (HUD)	Unavailable				✓					✓
Urban Revitalization and Livable Communities Act		Due in June			✓	✓					✓
Community Development Block Grants		Ongoing	✓			✓	✓		✓	✓	✓



KTUA Gets Projects Funded | \$169,416,000

Grants Written by KTUA	Awarded	Requested Funding	Year	Funding Source
Orange County Transit Authority On-Call Grant Writing: SR-55 Improvement Project	\$140,000,000	\$140,000,000	2020	California SB 1 Competitive Programs
City of National City 8th St. & Roosevelt Ave. Active Transportation Corridor Grant	\$5,500,000	\$5,500,000	2020	SANDAG Smart Growth Improvement Project and Active Transportation Grants
City of Escondido, Escondido Creek Trail	\$8,500,000	\$8,500,000	2020	CA Parks & Water Bond Prop 68
City of Vista Townsite Complete Street Improvements	\$3,968,000	\$4,177,000	2018	Caltrans Active Transportation Grant
City of Encinitas Rail Corridor Cross Connect Implementation Plan	\$210,000	\$210,000	2018	Caltrans Sustainable Transportation Planning Grant
City of Encinitas Modal Alternatives Project Implementation Plan (MAP Encinitas)	\$200,000	\$200,000	2018	Caltrans Sustainable Transportation Planning Grant
City of National City Waterfront to Homefront Connectivity Study	\$198,000	\$198,000	2018	SANDAG Active Transportation Grant Program Planning Projects
City of National City Roosevelt Avenue Smart Growth Revitalization Plan	\$2,080,000	\$2,080,000	2018	SANDAG Smart Growth Improvement Project Capital Projects
City of Lake Elsinore ATP Grant	\$175,000	\$245,000	2017	Caltrans Sustainable Communities
City of National City Community Corridor Studies- INTRA-Connect	\$330,000	\$330,000	2017	Caltrans Sustainable Transportation Planning
Port of San Diego Chula Vista Bayfront Parks	\$4,800,000	\$5,000,000	2017	Strategic Growth Council Urban Greening Grant
Uptown / University Heights Mobility, Safety and Urban Design Plan	\$250,000	\$250,000	2014	Caltrans Sustainable Transportation Planning
City of San Marcos Armorlite Drive Smart Growth Project	\$1,000,000	\$1,000,000	2013	SANDAG Trans Net SGIP
City of San Diego Complete Boulevard Mid-City	\$175,000	\$250,000	2013	SANDAG SGIP
City of National City SMART Foundation	\$300,000	\$300,000	2012	Caltrans Community Based Transportation Planning
City of National City 8th Street Smart Growth Project	\$2,000,000	\$2,000,000	2009	SANDAG SGIP
TOTAL AWARDED	\$169,416,000	\$170,240,000		

KTUA Gets Projects Built California

\$23,916,000

KTUA Prepared Grants Funded through Caltrans, Strategic Growth Council and SANDAG

\$53,679,000

Grant funding awarded based on plans/studies completed by KTUA

17 Projects

Funded since plans were completed

4 Park/Trail Projects

Submitted for 2019 Prop 68 Grants

Agencies receiving funding as a result of KTUA plans/studies



\$8,500,000	City of Escondido
\$3,968,000	City of Vista
\$5,261,000	City of Temecula
\$6,471,000	City of Eastvale
\$210,000	City of Encinitas
\$2,849,000	City of Moreno Valley
\$3,628,000	City of National City
\$1,000,000	City of San Marcos
\$772,000	City of Desert Hot Springs
\$19,725,000	City of Santa Ana
\$1,295,000	City of San Diego



SUCCESSFUL COMMUNITY ENGAGEMENT

Challenging projects, whether from a design, environmental or social equity perspective, require input from a variety of stakeholders, including the community, the client and the regulatory agencies. KTUA's goal is to gather public input, analyze the data and respond in a manner sensitive to stakeholder interest and concerns. Creating a forum for discussion, gaining the trust of the stakeholders and sharing information of value with them will result in project success.

An open mind, strong listening skills, and clear, concise information are key to this process. Understanding the best communication tools to encourage participation from our target audience is crucial and will vary from project to project. Public engagement methods utilized by KTUA

include workshop facilitation, design charrettes, walk audits, online surveys, websites, newsletters, interpretation, and translation.

No matter how much time and budget is allocated to the team to spend time on-site, site users will be more familiar with the project and environment than we are, and we feel that this input is beneficial to develop practical solutions. Publicizing workshops and community meetings is always a challenge. Different outreach methods work in different communities and demographics. By utilizing a wide range of tools, including social media, websites, emails, door-to-door distributed flyers, and personal invitations in the predominant community languages, KTUA reaches as many potential stakeholders as possible.



POWER OF ENGAGEMENT

INCLUSIVE	COLLABORATIVE	INFORMATIVE	FUN	EASY
<ul style="list-style-type: none"> all ages all abilities all stakeholders all interests all ideas all voices 	<ul style="list-style-type: none"> public meetings stakeholder meetings 1-1 interviews advisory groups focus/user groups formal presentations 	<ul style="list-style-type: none"> project website social media newsletters door hangers press releases public announcements 	<ul style="list-style-type: none"> community events site tours walk/roll/bus tours tactical urbanism pop up events farmers markets 	<ul style="list-style-type: none"> online maps/comments survey instruments 24 hour access virtual meetings multi-lingual family-friendly

KTUA GUIDING PRINCIPLES

- » Involve stakeholders early.
- » One person, one vote, one voice - don't let a few take over.
- » Address the issues, especially the difficult ones.
- » Build recommendations from the ground up and show how decisions were made.
- » Utilize a logical and sequential decision-making process to gain commitment and identify decisions and actions.
- » Listen, process, present with clarity, adjust and seek alignment.

CLIENT | COMMUNITY COMMENTS

“As a community representative, I have had the pleasure of working with KTUA on two particularly lengthy and sometimes contentious projects. On both projects, the KTUA team has done an outstanding job of taking input from sometimes angry and challenging citizens and distilling it into a comprehensive report or table. Throughout each project, I was repeatedly impressed by their ability to collect and compile masses of data and diverse, often conflicting, opinions into easily understandable charts, tables, diagrams, graphs and conceptual representations that were always made available well in advance of a subsequent public workshop or hearing.

It has long been clear to me that KTUA is not interested solely in doing a job but in doing each job in ways that will most benefit the community or communities of which they themselves are a part.”

Judy Swink, Community Representative

250 KTUA Outreach Projects

538 Chula Vista Bayfront Parks Online Comments

In-house multi-lingual staff **6**
(translation | interpretation)

SUPPORT SERVICES | VISUALIZATIONS



KTUA employs web GIS, or tools that allow spatial data to be hosted on the web and shared with users in a variety of formats. Users interacting with web GIS tools are able to view, manipulate and create spatial data for all aspects of transportation and other projects.



Procedural modeling techniques rapidly generate 3D content based on a set of rules. KTUA most commonly relies on ESRI's CityEngine to perform this type of modeling which uses GIS as the base, and custom CGA scripts to apply extrusions, densities and textures to geographic data. Procedural modeling allows KTUA to quickly generate large areas of 3D content for use in a variety of visualization applications.

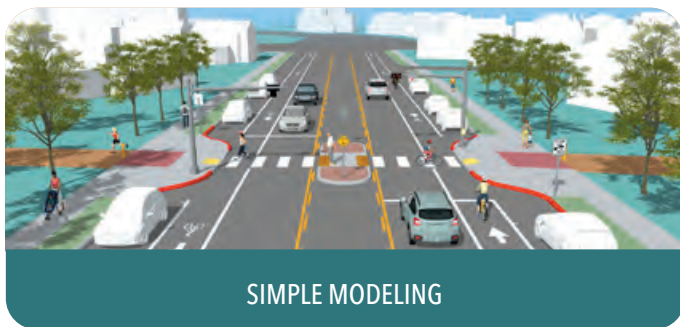

KTUA leverages their vast library of 3D content as well as the latest procedural modeling tools to rapidly generate realistic 3D representations of projects. 3D models help convey proposed changes to the community and can be used in conjunction with photography and videos to create photorealistic content.



KTUA develops visual simulations, or photo simulations, that involve the use of various software packages to overlay a 3D model of a proposed design over a high quality photograph of the location. Simulations allow the community more easily to visualize the aesthetic impact of proposed projects.



Enhanced 3D models using advanced rendering applications simulate realistic lighting, shading, reflections and atmospherics. This realistic rendering is typically done towards the end of a modeling process or phase, allowing the model to be illustrated in a photo-realistic manner. The enhanced rendering can be exported as a still image or animation.



KTUA captures high resolution photography throughout the life of projects, documenting site conditions, outreach events and tactical urbanism installations. Photographs are most commonly used to illustrate the planning process in reports, and augment 3D models through simulations. Videos are also used to document the life of a project as well as to create realistic fly-throughs of 3D models [Watch Video.](#)

Port of San Diego Chula Vista Bayfront Parks Master Plan



The Chula Vista Bayfront project represents one of the largest waterfront developments in Southern California. KTUA and its team of consultants have been working with the Port of San Diego and the City of Chula Vista since 2016 on the master planning, programming and design of the two waterfront park sites associated with the project. Harbor Park (21 acres) provides signature amenities, recreational opportunities, and programming adjacent to the resort hotel and convention center. Sweetwater Park (62 acres) connects visitors with the unique ecosystem of San Diego Bay, enhances and protects sensitive habitat resources, and provides environmental exploration and family-oriented recreation.

An extensive path system will wind through the park providing exercise opportunities and connecting park users to natural recreational features such as grassy mounds, dunes, a dry creekbed and basin system, and several overlooks with views to the bay. Interpretive elements and programs will be interwoven amongst the park features to inform and enrich all park users. Trails were an important component of the project. A total of 3.5 miles of trails are proposed in Sweetwater Park alone. Most of the trails being constructed are DG paths that are 4' or 11' in width. The Promenade multi-use path represents nearly one mile of a 14' wide pavement with adjacent DG pathways, connecting Harbor Park with Sweetwater Park. The primary experience and activity expected will be walking, hiking, biking and bird watching. The trail system supports this focus.

KTUA's scope included: site planning; a program and spatial requirements summary; a review of all Port, Chula Vista and Coastal Commission requirements including settlement and environmental mitigation requirements; construction cost estimates for establishing project budgets; phasing recommendations; trail width and connectivity requirements; an interface study with adjacent buildings; presentations to the Wildlife Advisory Group; presentations to the Bayfront Cultural Design Committee; the preparation of design guidelines and a wayfinding program for the entire bayfront development including streets, waterfront access, and development sites; and the development of 3D models and animations for meetings and presentations.

GRANT WRITING SERVICES

KTUA successfully prepared and secured a \$5M California Natural Resources Agency Urban Greening Grant for Sweetwater Park. The grant addressed biological and hydrological resources and developed a mitigation monitoring, maintenance, and contingency plan for implementation. Additional grant funding opportunities are currently being explored.

Public engagement is a critical component of the project and the team has implemented a wide-reaching and inclusive outreach program that includes hands-on workshops, public presentations, site walks, and on-line surveys. More than 500 survey responses were received on the parks, and attendance at the each workshop averaged 150 to 200 people.

VISUAL TECHNOLOGY



Landscape improvements to the Fairmont Grand Del Mar linear fountain terrace.



Port of San Diego Chula Vista Bayfront Parks



HUD Design Guidelines for Walkable and Bikeable Communities

KTUA created a set of guidelines for elected officials, planning staff, community organizations and other interested parties to promote and create bicycle and pedestrian friendly neighborhoods and communities. The guide includes solutions tailored to small and mid-sized cities (population < 200,000) throughout the nation, particularly those with a high percentage of low and moderate income (LMI) individuals.

The guidelines are graphically-rich and accessible to a range of users. Key components include a discussion of the benefits and barriers of walking and biking; a community self-assessment tool; a planning process guide; design guidelines for land use, streets, intersections, bikeways and pedestrian facilities; an implementation guide; and case studies showing real world examples of pedestrian and bicycle improvements in comparable communities. To ensure the guidelines reflect best practices and the diversity of intended users, a Review Committee – comprising nationally renowned planning experts – provided project oversight.

A comprehensive community self-assessment tool was devised for guideline users to evaluate their community's walkability and bikeability. The tool's greatest strength is its inclusion of a menu of data collection and assessment approaches that allows guideline users to select methods based on level of effort and resources required. This makes the guidelines accessible to a range of users and agencies, irrespective of level of sophistication and/or capacity.

The design guidelines use 3D models, images and other graphics to demonstrate complex concepts, in particular the coordination of different design elements required to create walkable and bikeable places. Design guidelines are presented as succinct written directives, identified by unique codes (e.g. BG-4), and supported by 3D models illustrating the concepts. These codes are intended to simplify implementation and facilitate the funding processes.

VISUAL IMPACT ASSESSMENTS

National City 8th Street Revitalization



Existing Conditions



Phase 3 Condition



Final Proposed Daytime Conditions



Final Proposed Nighttime Conditions



Existing Conditions



Proposed Conditions

Chula Vista Bayfront Master Plan EIR



Existing Conditions



Proposed Conditions

El Camino Real Road / Bridge Widening Project EIR

Existing Conditions



A coastal access and slope stabilization project for the City of Encinitas along a popular beach waterfront edge. The existing facility had several landslides, excessive erosion and shoreline stability failures. This popular beach for surfers and beach goes includes a parking lot and beach viewing area on top of the bluff and a trail connecting the parking lot with the beach.

Beacons Beach Visual Impact Assessment

Proposed Conditions



The project proposed new trails, slope stabilization and a natural appearing seawall. KTUA completed the visual study and water quality study for the proposed project. The impact study included extensive computer simulations, adjacent viewer analysis and view corridor assessments. Suggested mitigations for the seawall were also included in the project.

COMMUNITY CHARACTER STUDIES



Hymettus Estates Community Character Study - Nine single family residences and easement for a bioretention basin on a 2.25 acre site View Document: http://issuu.com/ktua/docs/hymettus_estates

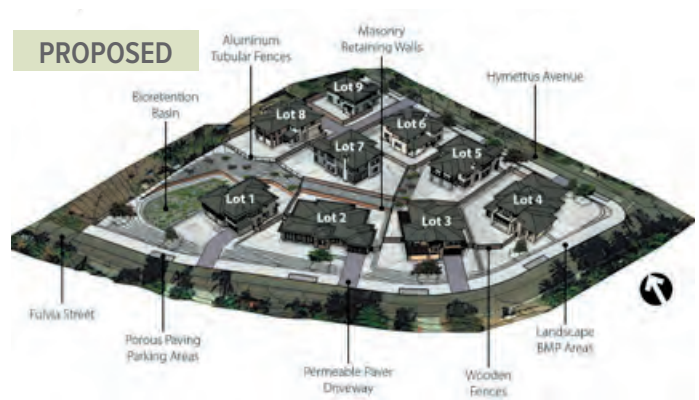
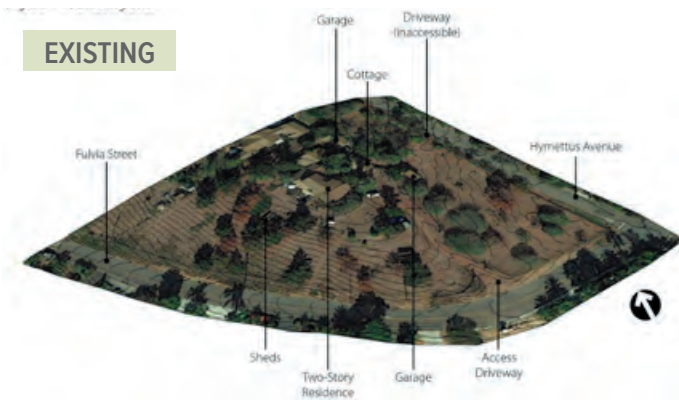

Veritas Requeza Community Character Study - 13 single family residences on a 4.6 acre site

PUBLIC SAFETY



Pablo Mason Photography. Jeff Katz Architecture.

Garden Grove Fire Station #6 and Community Building

The new Garden Grove fire station and community building occupies the SW corner of the existing West Haven Park site in the City of Garden Grove. As part of the selected DB-E team, KTUA worked with the City of Garden Grove to providing park Improvements for a large new play structure with resilient surfacing for children of varying ages and abilities, seating and picnic tables around the play structure and community building, as well as reconnecting walkway systems that were impacted with the new improvements.

KTUA worked with the civil engineer to coordinate the proposed bioswale locations to capture storm water runoff. Care was given to protect in place the existing trees found on the site. The scope of work also included construction administration services. Fire Station No. 6 is a full-function, modern day, public service facility. The 7,860 square-foot facility includes an apparatus bay, front office, visitor lobby, laundry facility, kitchen and dining room, day room, and eight bunk rooms.



Pablo Mason Photography. Jeff Katz Architecture.

County of Santa Barbara Probation Headquarters

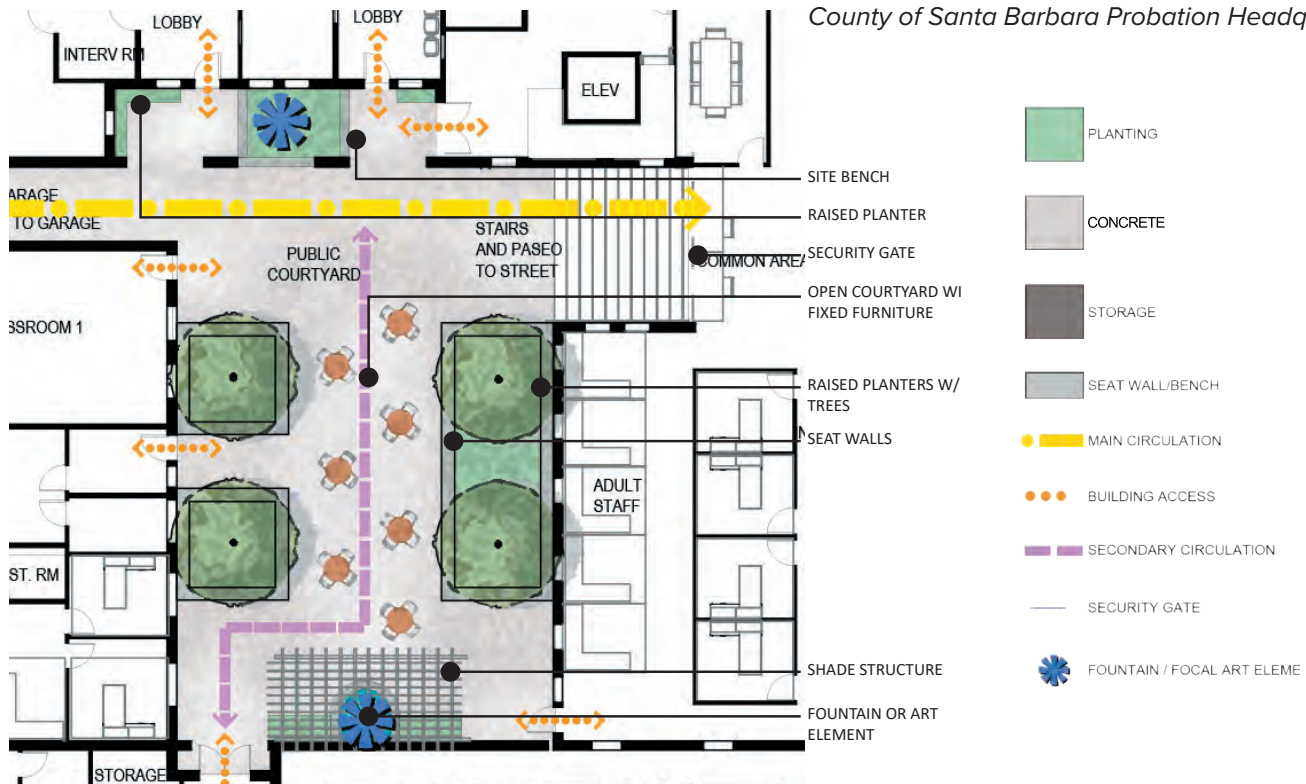

County of Santa Barbara Probation Headquarters

The County of Santa Barbara probation building is located in the heart of downtown Santa Barbara a block away from the County Courthouse building and within the El Pueblo Viejo Historic District. The project entails conceptual and schematic design drawings for the County in preparation for the development of bridging documents for a design-build project. Working closely with the architect, engineering trades, and the County, KTUA produced various options that fit within the historic context of the neighborhood and functionally work for the user types anticipated for the project. State-of-the-art sustainability practices are incorporated to achieve Net Zero Energy (NZE). The team coordinated with General Services, Facilities/ Building Maintenance and the Department of Public Works to incorporate County standards and determine sustainable maintenance and energy goals. A customer friendly aesthetic was developed in conjunction with advanced security features including Crime Prevention Through Environmental Design (CPTED). The project features ground level plaza spaces, streetscape design, and various rooftop plazas and garden spaces. The rooftop spaces feature overhead shade structures, fountains, and planting to help make the spaces comfortable for the users.

Rancho San Diego Sheriff Station



Public Safety Experience:

- City of Garden Grove Fire Station #6
- City of San Diego Golden Hill Fire Station
- City of San Diego Carmel Valley Fire Station
- County of San Diego Rancho San Diego Sheriff Substation
- County of San Diego Rancho Santa Fe Sheriff Station
- County of San Diego Medical Examiners Building
- Murrieta Fire Protection District Murrieta Fire Station
- Rancho Santa Fe Fire Protection District Rancho Santa Fe Fire Station